

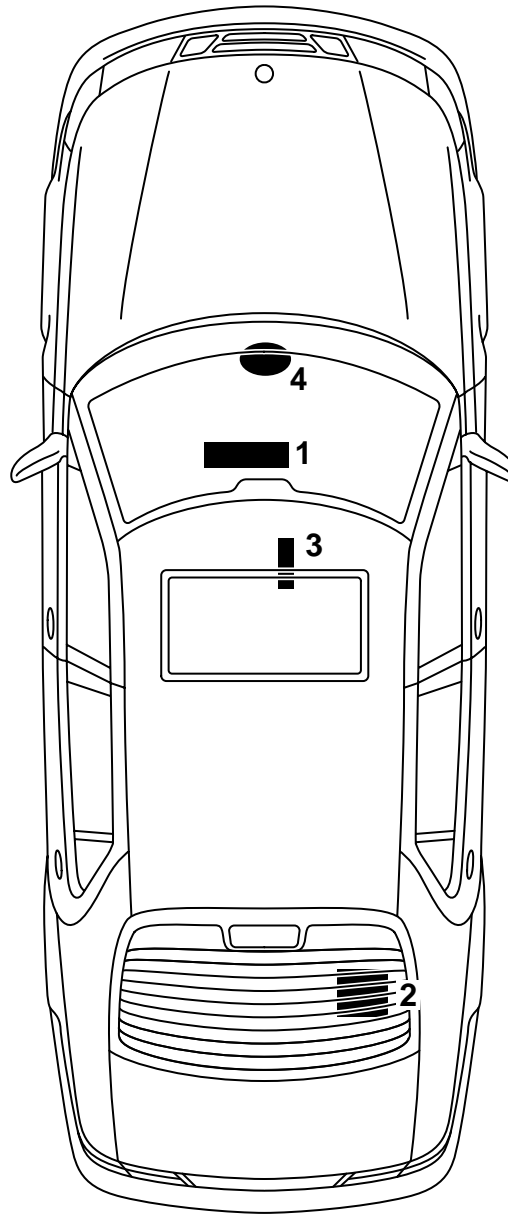

**MONTERINGSANVISNING · INSTALLATION INSTRUCTIONS
MONTAGEANLEITUNG · INSTRUCTIONS DE MONTAGE**

Saab 9-5
Navigation system

Accessories Part No.	Group	Date	Instruction Part No.	Replaces
400 132 239	9:51-01	Jan 02	86 97 229	86 97 229 Apr 01

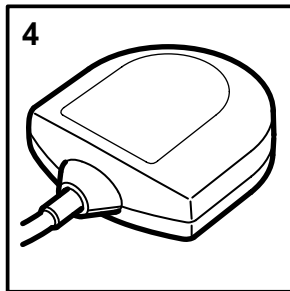
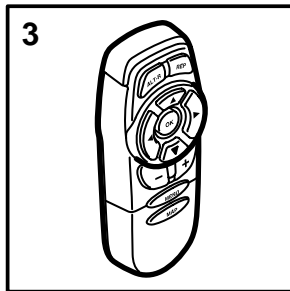
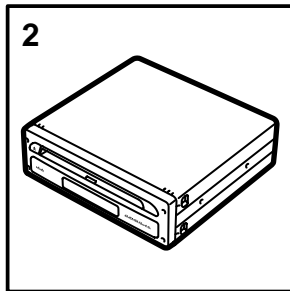
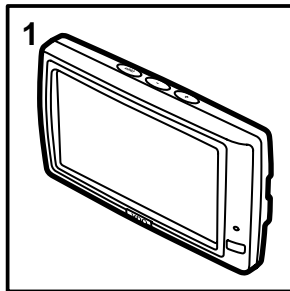

E338D016

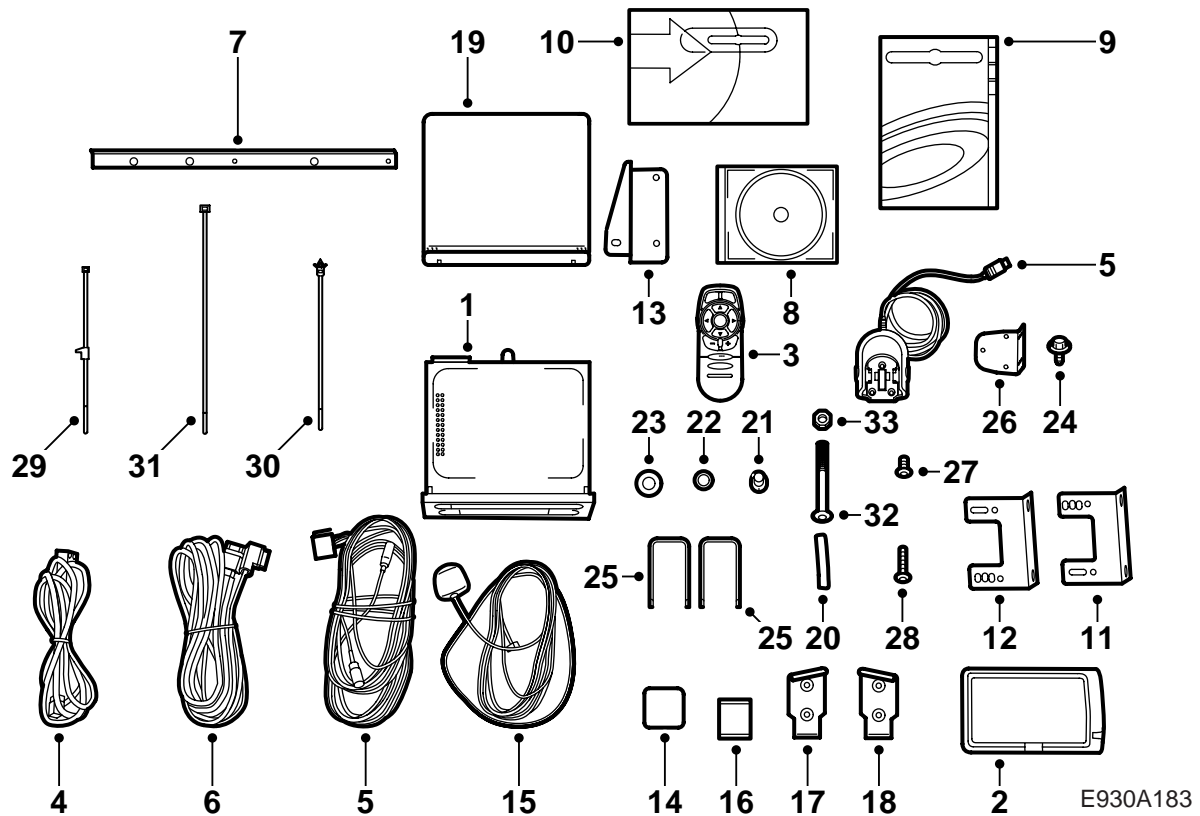

E930A183

- 1 Navigation unit
- 2 Screen
- 3 Remote control
- 4 Wiring harness, navigation unit
- 5 Wiring harness, remote control
- 6 Wiring harness, screen
- 7 Lid support, storage compartment
- 8 CD for language selection
- 9 User instructions
- 10 Reply coupon
- 11 Attachment bracket, navigation unit (marked 1)
- 12 Attachment bracket, navigation unit (marked 2)
- 13 Attachment bracket, navigation unit
- 14 Grounding surface, GPS antenna
- 15 GPS antenna
- 16 Adhesive tape
- 17 Attachment bracket, screen (LHD)
- 18 Attachment bracket, screen (RHD)
- 19 Mounting frame, navigation unit
- 20 Wear protection
- 21 Bolt M4x6 (x4)
- 22 Locking washer (x4)
- 23 Washer (x4)
- 24 Bolt 4.8x16 (x4)
- 25 Stirrup (x2)
- 26 Attachment bracket, remote control

- 27 Bolt M3.5x8 (x3)
- 28 Bolt 3.5x16 (x3)
- 29 Cable tie with holder (x3)
- 30 Cable tie with clip (x7)
- 31 Cable tie, long (20)
- 32 Bolt (x2)
- 33 Nut (x2)

The installation instructions are divided into two sections:

- fitting in LHD cars, page 3
- fitting in RHD cars, page 23

Important

The system is sensitive to static electricity. It is essential that you first ground yourself on the car, by touching the engine for example, before handling the electronic components. Avoid touching the IR windows on the screen and remote control for example.

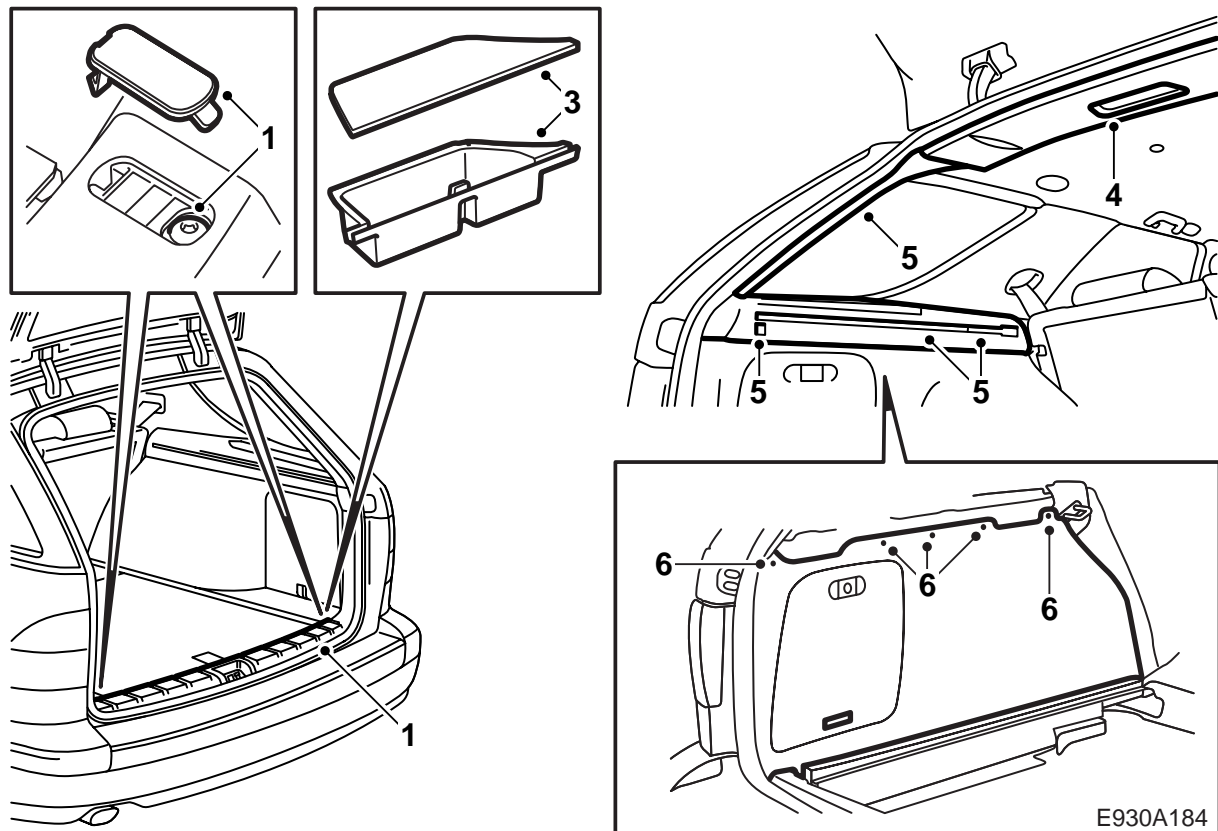

LHD

Disconnect the battery before commencing.

- 1 **5D:** Remove the luggage cover.
- 2 **5D:** Lower the left-hand rear backrest and remove the cover between the rear left door and the backrest.
- 3 **5D:** Remove the left-hand storage compartment in the floor.
- 4 **5D:** Remove the rear roof moulding and unplug the connections for the lighting.
- 5 **5D:** Remove the left-hand D-pillar trim and remove the left-hand luggage cover support (3 screws).
- 6 **5D:** Remove the screws from top of the left-hand side trim and lift out the left-hand side trim.
- 7 **5D:** Repeat steps 2-3 and 5-6 on the right-hand side of the car.
- 8 **5D:** Remove the luggage compartment floor and the clips at the front of the mat over the spare wheel.

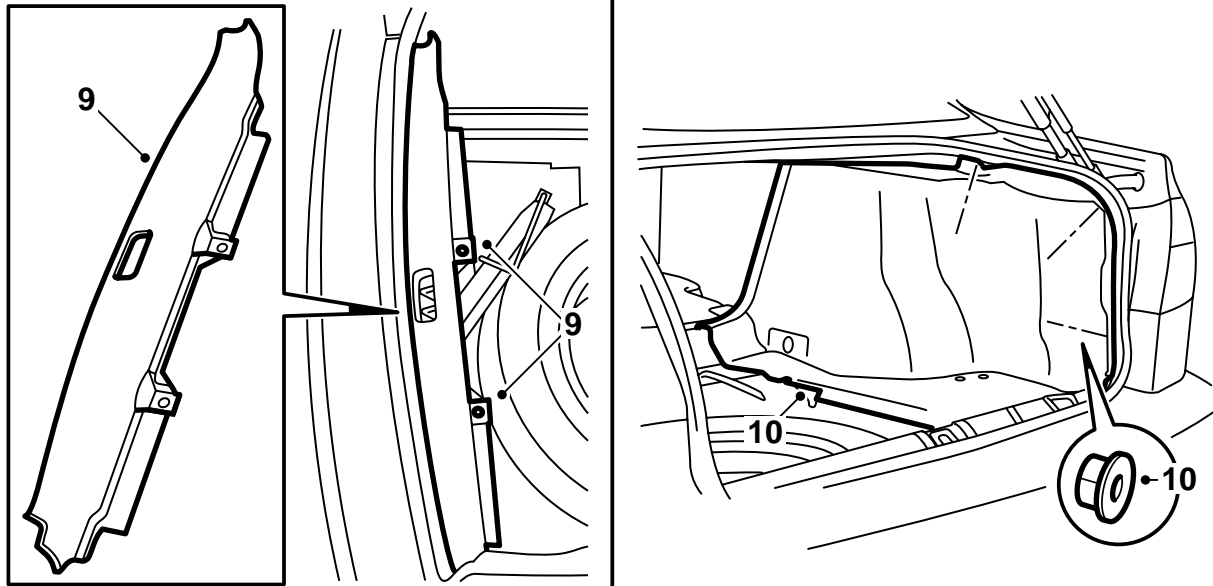

E930A185

- 9 **4D:** Remove the luggage compartment scuff plate.
- 10 **4D:** Remove the right-hand side trim in the luggage compartment and the luggage compartment floor.

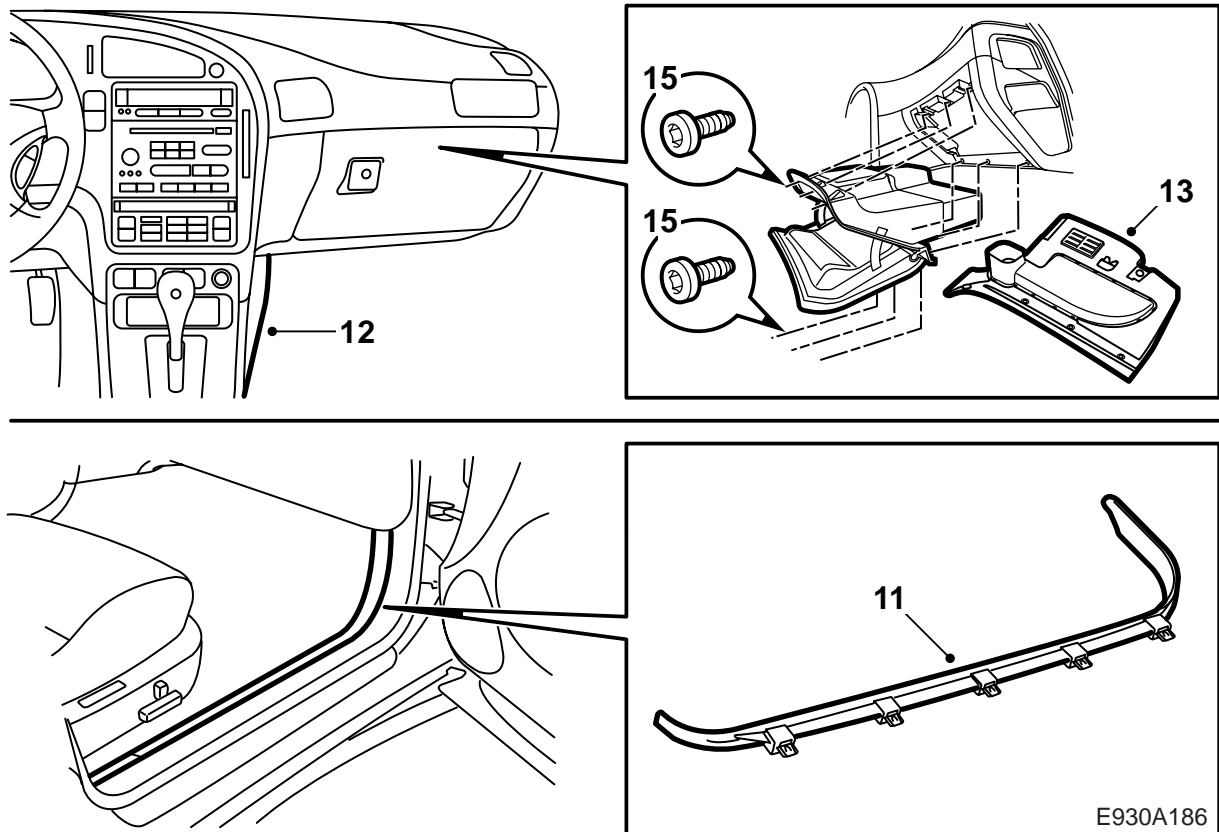

- 11 Remove the scuff plates on the right-hand side of the car.
- 12 Remove the cover on the heating and ventilation unit.
- 13 Remove the lower dashboard panel under the glove box, 4 bolts. There are clips at the front.
- 14 Detach the floor illumination from the lower panel.
- 15 Undo 3 retaining screws under and 3 retaining screw inside the glove box, pull out the glove box a short way and unplug the connector for the glove box light.
- 16 **Cars with A/C:** Detach the cooler hose.
- 17 Remove the glove box and air duct.

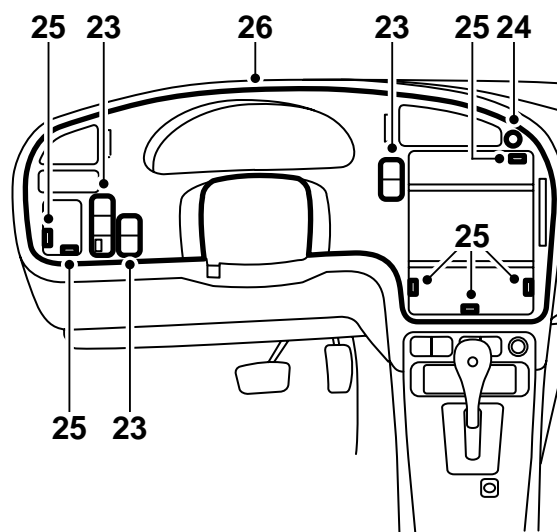
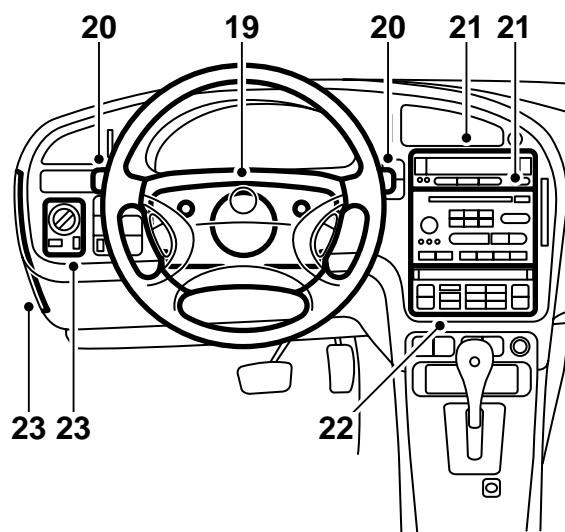

E930A187

- 18 Pull out the steering wheel to outermost and lowermost position.
- 19 Remove the top and bottom steering column covers, 3 screws.
- 20 Detach the switches for the direction indicators and windscreen wipers.
- 21 Remove the SID unit and the radio section. Unplug any connections and the antenna.
- 22 Remove the heating and ventilation panel and dismantle the connector.
- 23 Remove the main fuse board cover on the side of the panel. Remove the light control panel and the other switches and connectors.
- 24 Detach the switches for the hazard flasher and the connector.
- 25 Remove the instrument plate, 6 bolts and 4 clips.
- 26 Lift away the instrument plate.

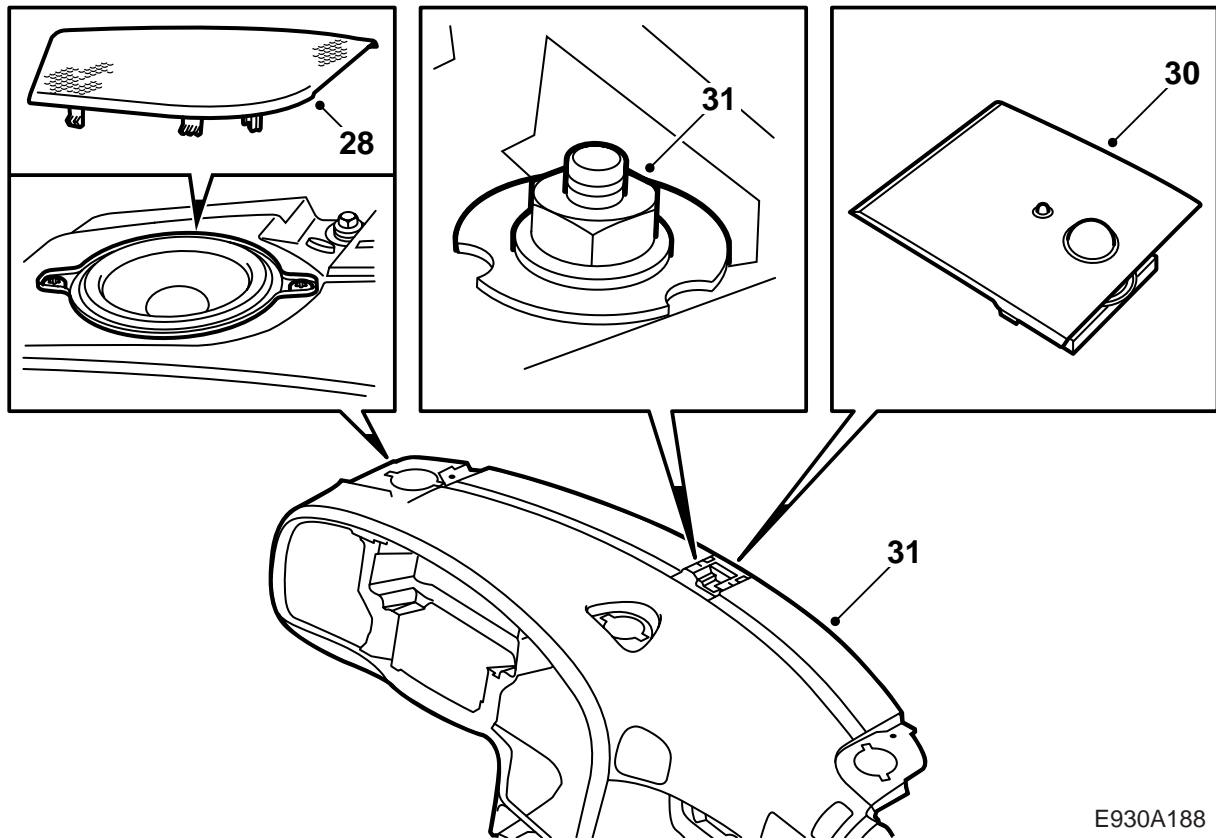

E930A188

- 27 Remove the A-pillar trim.
- 28 Remove the loudspeaker grille on both sides.
- 29 Remove the defroster cover clips on both sides.
- 30 Remove the cover with solar sensor and flasher diode.
- 31 Undo the nut for the defroster cover, the hole is elongated, and lift away the defroster cover.

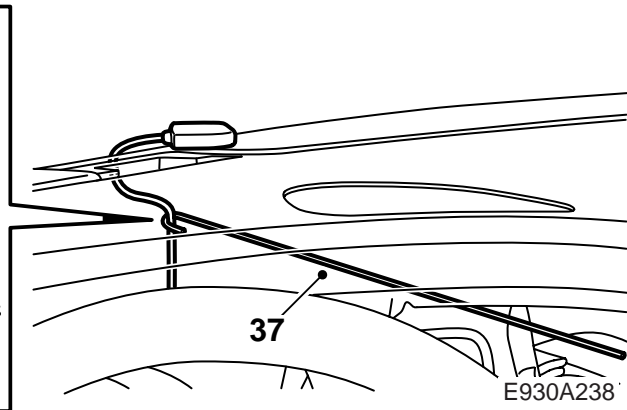
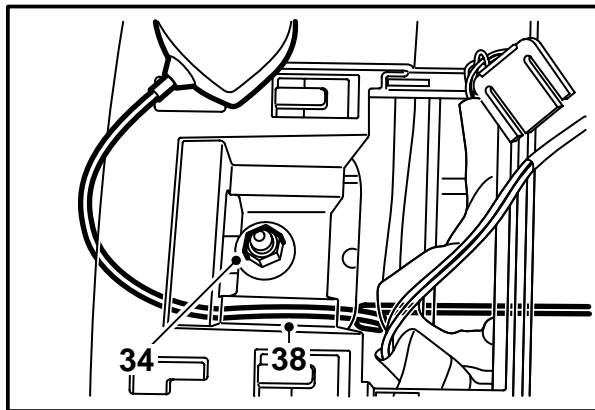
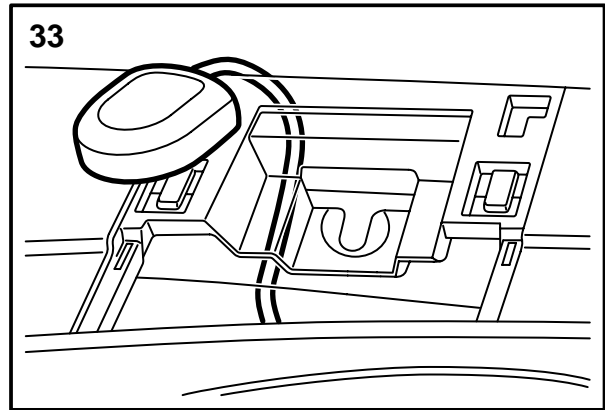
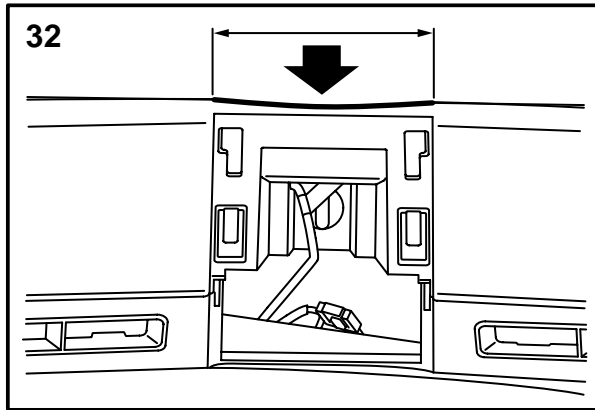

E930A238

- 32 Round off the middle of the cover with a file to prevent the GPS antenna wiring harness from chafing against sharp edges.
- 33 Run the GPS antenna wiring harness around the front of the cover.
- 34 Position the defroster cover and tighten the nut. Make sure the length of the wiring harness can be adjusted easily.
- 35 Fit the clips and the loudspeaker grilles on both sides.
- 36 Fit the A-pillar trim.
- 37 Insert a bent welding rod inside the dashboard over the centre ventilation duct towards the position for the solar sensor.
- 38 Place the GPS antenna wiring harness so that it can be pulled out using the welding rod.

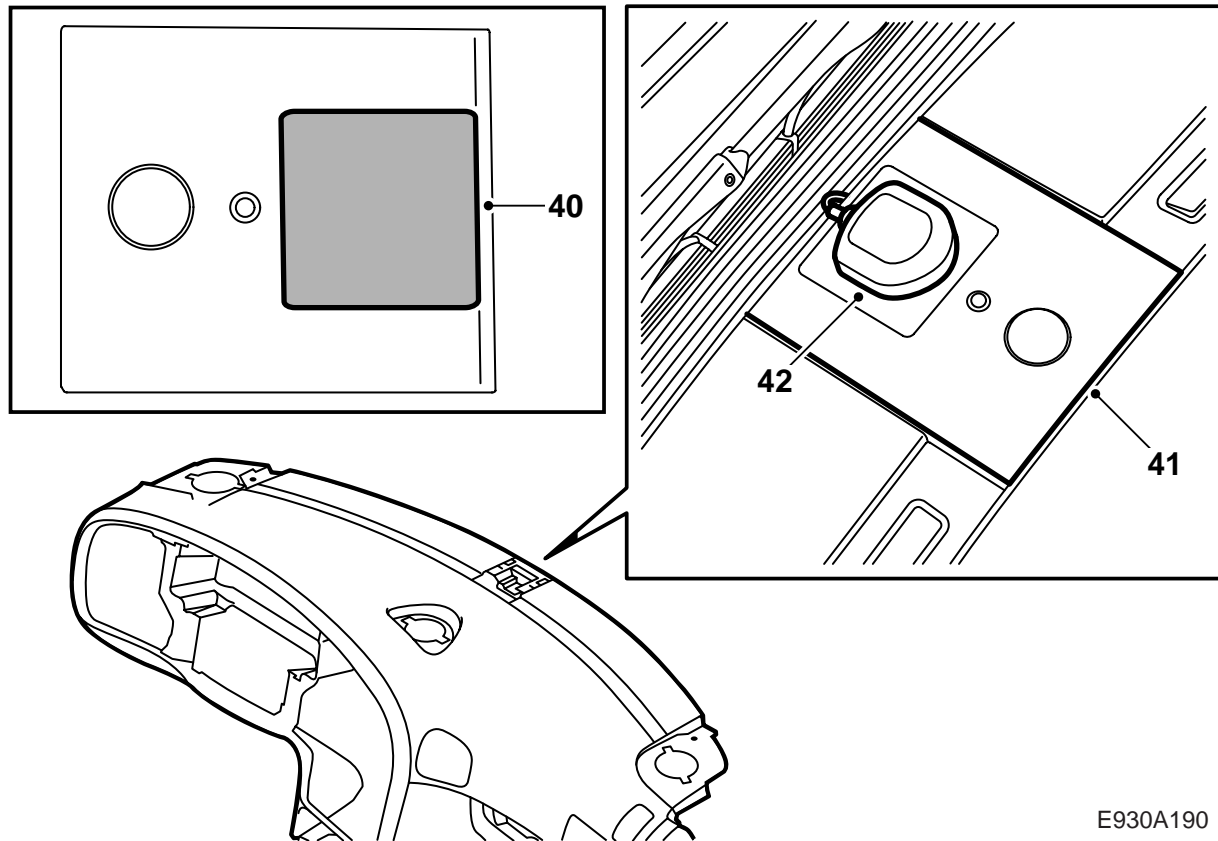

E930A190

- 39 Clean the surface on the GPS antenna grounding surface with white spirit where the tape is to be affixed. Affix the tape to the GPS antenna grounding surface.
- 40 Clean the surface on the cover with the solar sensor with white spirit where GPS antenna is to be mounted in the centre and fit the GPS antenna grounding surface with its holes in the longitudinal direction of the car.
- 41 Connect the solar sensor and flasher diode and fit the cover.
- 42 Fit the GPS antenna in the centre of the attachment plate. The GPS antenna is magnetic.

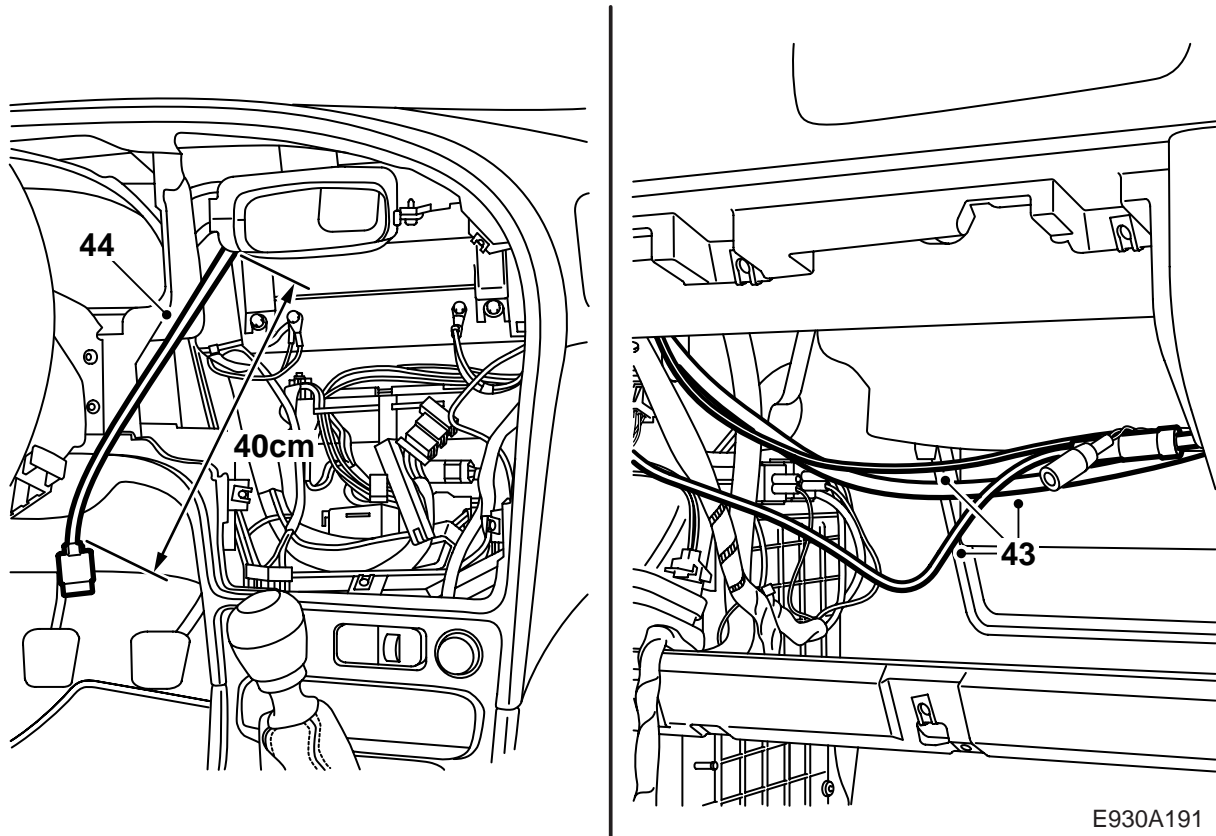

E930A191

- 43 Move the GPS antenna wiring harness to the right towards the existing wiring harness behind the impact member (airbag).
- 44 Run the screen wiring harness via the glove box along the existing wiring harness channel and under the centre air vent in the dashboard, allowing about 40 cm to protrude from the heating and ventilation unit.

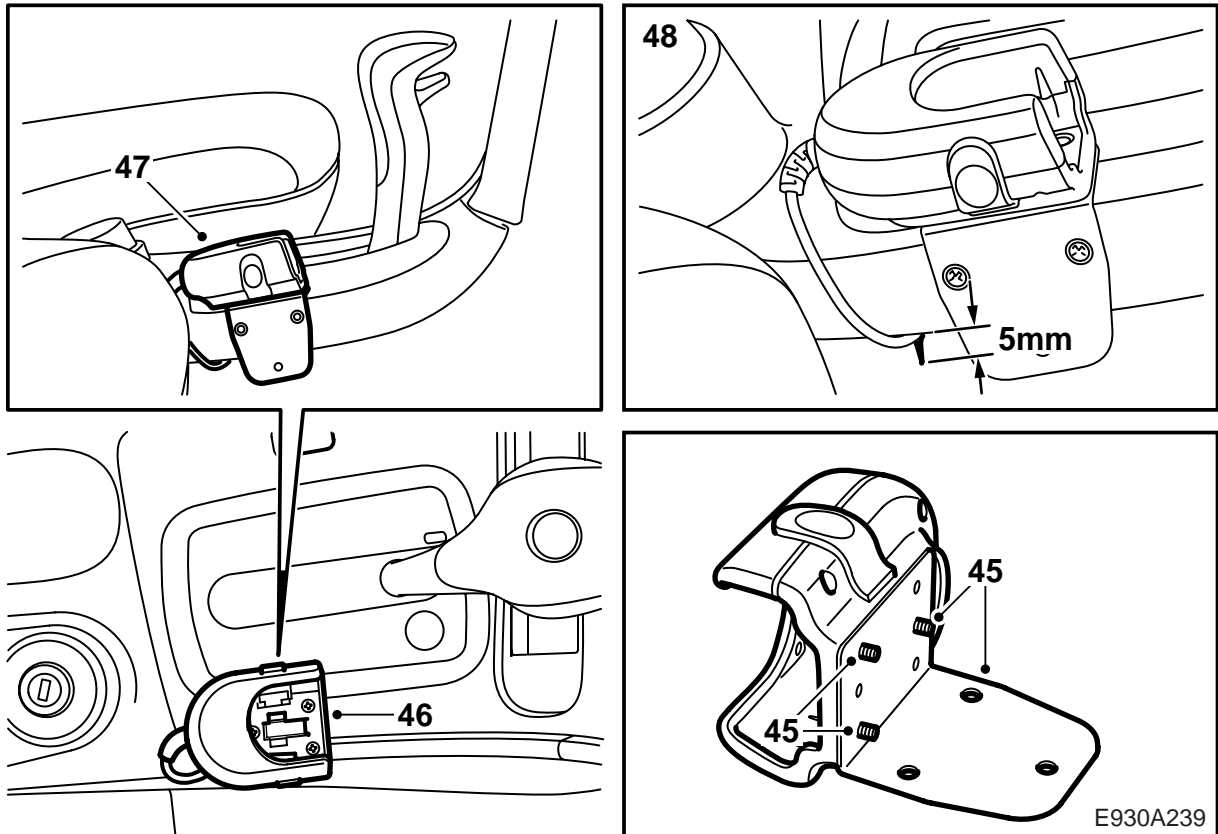

- 45 Assemble together the console for the remote control and the remote control attachment bracket with three screws.
- 46 Place the remote control console on the centre console to the right of the gear lever, about 20-25 mm in front of the ignition switch. The screws for the remote control carrier must not reach the centre console.
- 47 Drill a 2.5 mm hole using the bracket as a template. Secure it with one screw and drill the second hole. Attach the console with two screws.
- 48 Cut a 5 mm long slit in the carpet along the back edge of the remote control console. Measure the length from the join between the carpet and the centre console.
- 49 Remove the remote control console and fold away the carpet.

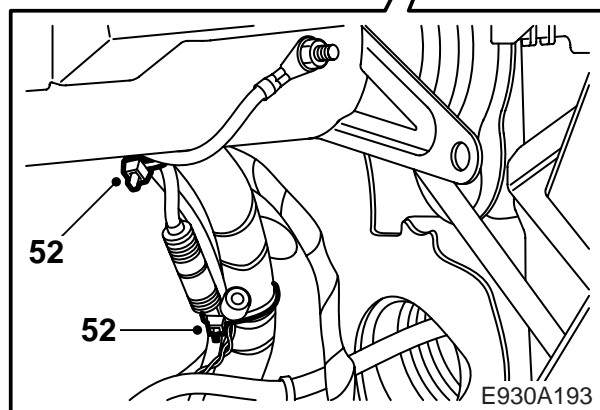
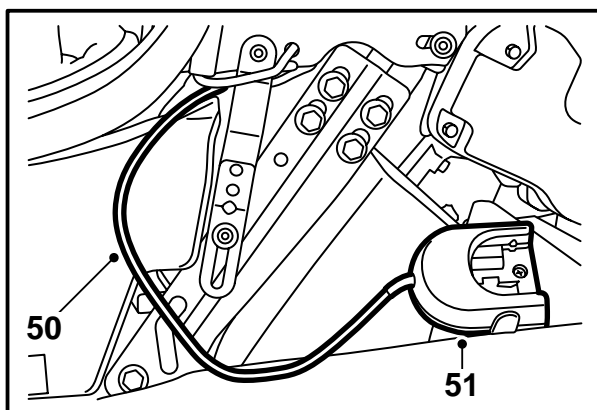
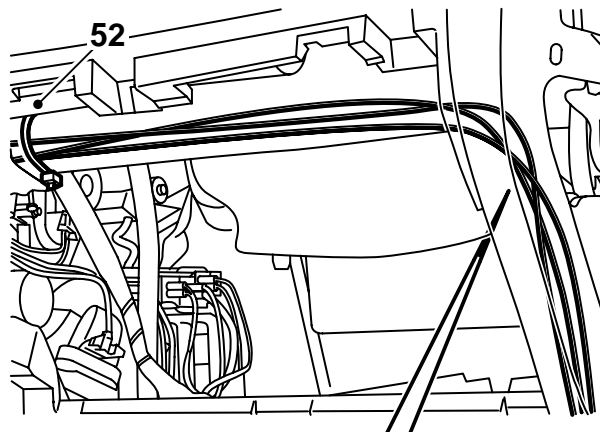
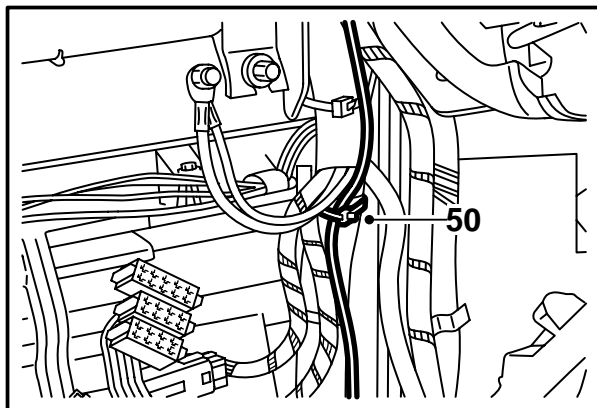

E930A193

50 Run the remote control wiring harness behind the floor carpet by the centre console, along the existing wiring harness towards the space behind the radio and then to the right, where it connects to the remote control wiring harness. Place the connectors behind the glove box as close to the right-hand A-pillar as possible.

The wiring harness from the remote control has a connector that is intended for an extra loudspeaker. This connector is not used and is to be secured together with the other connectors.

51 Position and fit the carpet and the remote control console.

52 Gather up all the wiring harnesses and secure them with 2 cable ties to the member behind the passenger airbag.

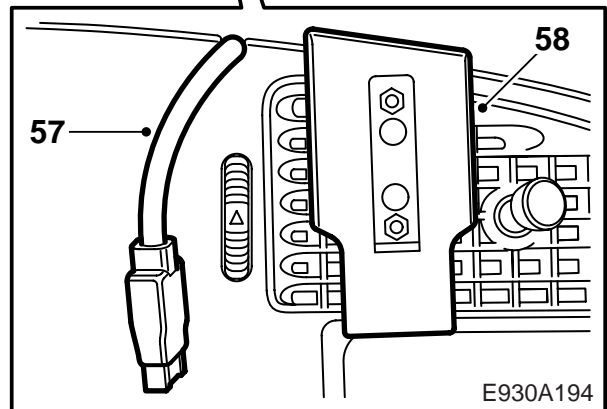
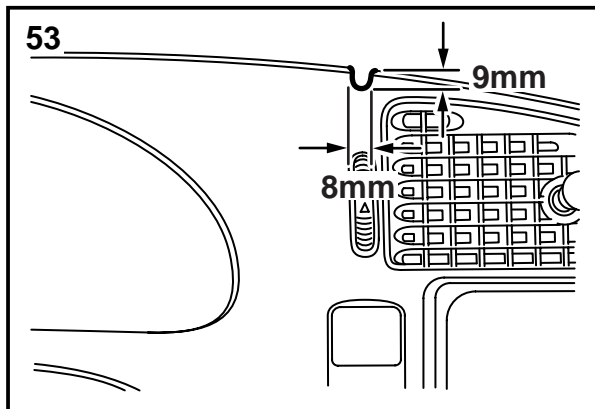
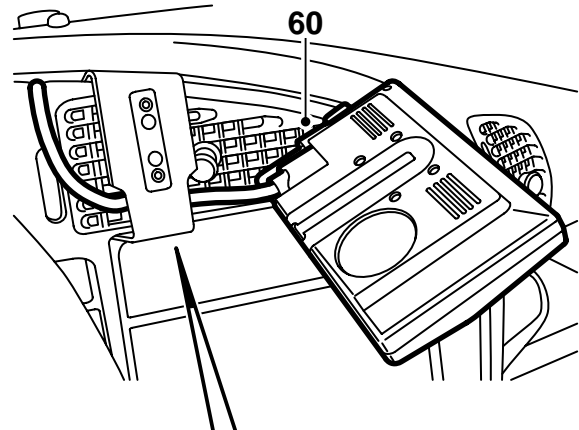
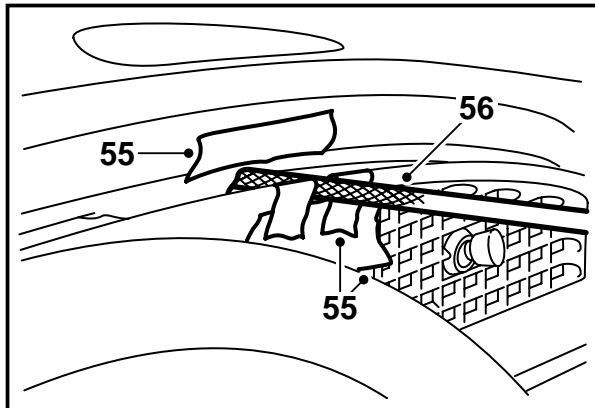

E930A194

- 53 Make a hole 8 mm wide and 9 mm high with a file on top of the instrument plate above the air vent shutter control. Check that the screen wiring harness can be placed easily in the hole.
- 54 Position the instrument plate in the dashboard without snapping it on. Check from the driver side that the air ducts are positioned correctly.
- 55 Affix a piece of tape on the dashboard by the filed hole in the instrument plate and affix tape around the filed hole in the instrument plate.
- 56 Carefully file a hole in the dashboard through the hole in the instrument plate.
- 57 Place the screen wiring harness into the hole and make sure the wiring harness fits easily into the filed hole.
- 58 Fit the screen mounting bracket to the instrument plate.
- 59 Press on the instrument plate.

⚠ WARNING

Take care when fitting and make sure none of the connectors or cables are jammed.

- 60 Connect the wiring harness to the screen and fit the screen into the mounting bracket.
- 61 Adjust the length of the wiring harness. It should be possible to remove the screen if necessary.

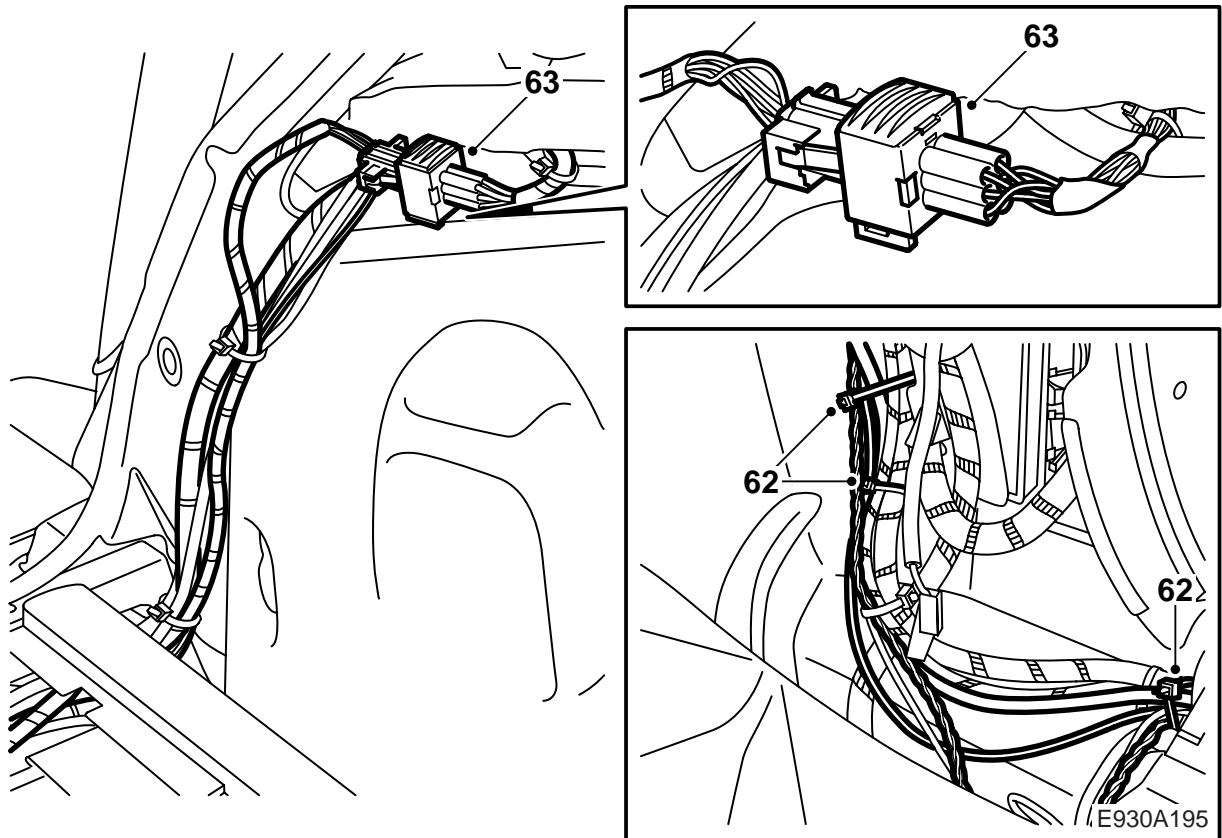

- 62 Run the wiring harness down towards the wiring harness channel in the right-hand skill and on towards the rear wheel housing. Secure the wiring harness with 3 cable ties at the A-pillar, 1 cable tie at each end of the wiring harness channel (4 pcs) and 2 cable ties at the front of the rear wheel housing.
- 63 The cable harness has been prewired for the navigation system at the rear wheel housing. Cut off any cable ties present and connect the wiring harnesses.

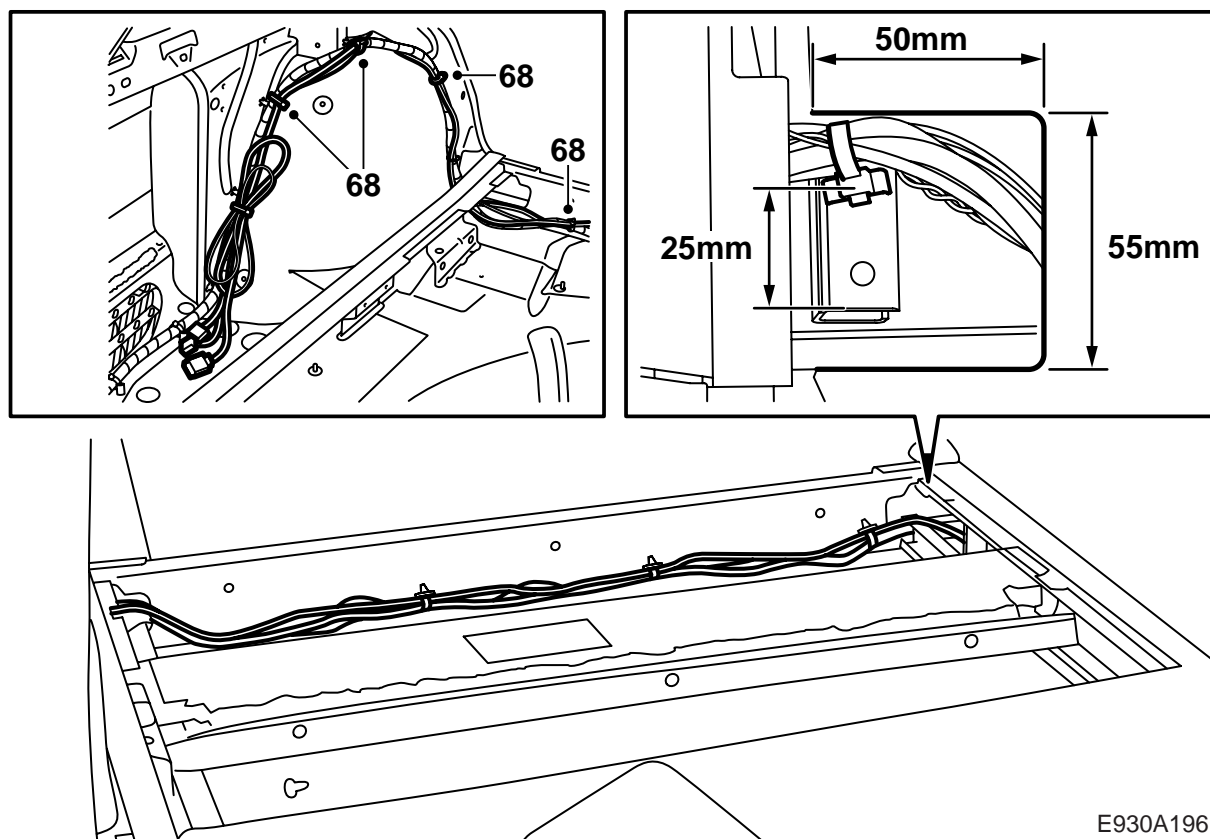

E930A196

- 64 **5D:** Run all the wiring harnesses along the member behind the rear seat backrest and secure them together with any other wiring harnesses. If there are no other wiring harnesses, use cable ties to secure the wiring harness for the navigation system to the 5 holes in the body.
- 65 **5D cars with extendable luggage compartment floor:** Cut out both sides of the carpet to allow the wiring harness to pass over the rails on the luggage compartment floor. The cut-out should be 55 mm long, measured from the front fold of the carpet towards the rear of the car, and 50 mm wide, measured from the edge of the carpet towards the centre.
- 66 **5D cars with extendable luggage compartment floor:** Check whether there are any holes 25 mm from the front of the rails for the front wheels of the luggage compartment floor. If there are not any holes, drill 6.5 mm holes in each rail. Drill the holes 25 mm from the front of the rails.
- 67 **5D cars with extendable luggage compartment floor:** Secure the wiring harness to the luggage compartment floor rails using cable ties and clips. Adjust the cut-out in the carpet as necessary.
- 68 **5D:** Run the wiring harnesses along the left wheel housing via the car's wiring harness down to the where the navigation unit is located.

Important

The carpet must not lie on top of the wiring harness as this will affect the function of the extendable luggage compartment floor.

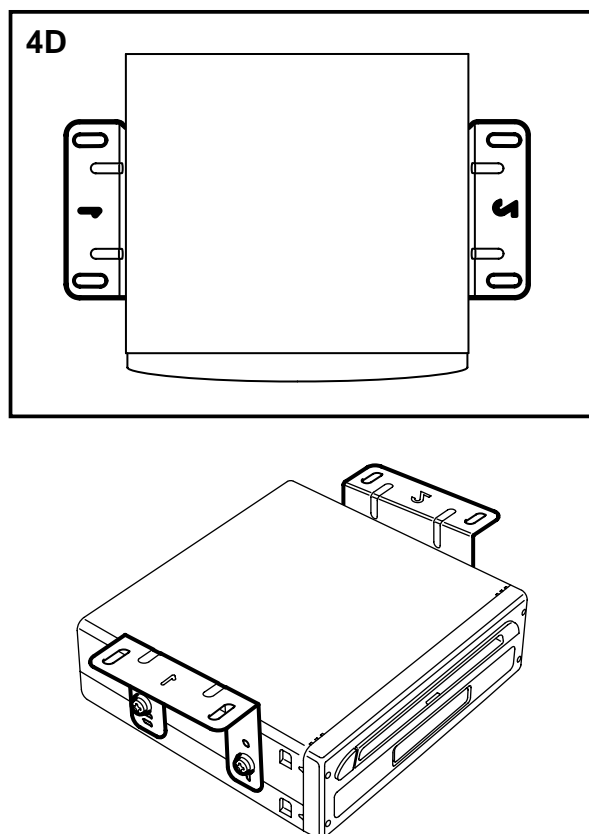

5D

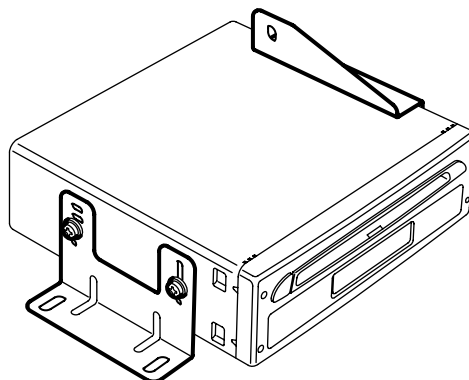

E930A197

- 69 Fit the rubber guide on the pin on the rear of the navigation unit and insert the navigation unit into the mounting frame.

Important

The depression in the mounting frame must be located underneath the navigation unit.

Press in the navigation unit until it snaps into the mounting frame and then fit the brackets to the mounting frame.

4D: The angle bracket marked 1 must be fitted on the LH side of the navigation unit and the angle bracket marked 2 must be fitted to the RH side of the navigation unit. The rear screw must be located in the horizontal oval hole closest to the circular hole and the front screw must be located in the vertical oval hole.

5D: The angle bracket marked 2 must be fitted on the LH side of the navigation unit and the stepped bracket must be fitted to the RH side of the navigation unit. The rear screw in the LH bracket must be located in the horizontal oval hole closest to the circular hole and the front screw must be located in the vertical oval hole.

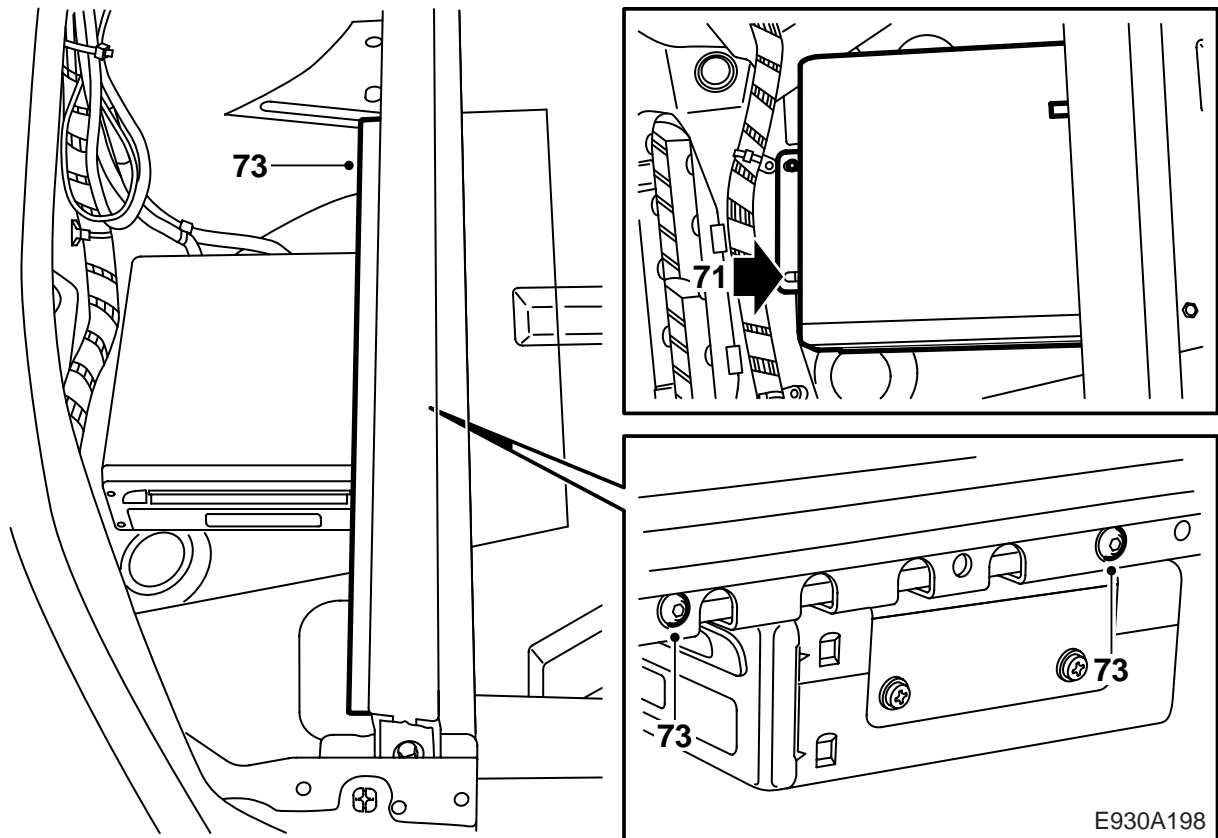

70 Connect the navigation unit.

71 **5D:** Detach the wiring harness cable tie from the weld stud, position the navigation unit with the weld stud in the front attachment hole on the left-hand side and the right-hand bracket secured to the load anchor rail. Make a mark through the rear hole on the left-hand side of the navigation unit.

72 **5D:** Lift away the navigation unit and drill a 3.5 mm hole at the mark.

Deburr the hole and remove any loose cuttings and flakes of paint. Clean with Teroson Cleaner FL, apply Standox 1K Füllprimer and apply finishing paint. Use Terotex HV 400 underneath the body.

73 **5D:** Fit the navigation unit with the weld stud in the front attaching hole on the left-hand side, one screw in the drilled hole and the right-hand bracket fitted to the load anchor rail together with the support for the left-hand storage compartment lid. Lift up the navigation unit as high as possible when tightening the screw in the load anchor rail. If the car is equipped with extendable luggage compartment floor, the screws for its front attachment must be used.

Attach the wiring harness cable tie to the weld stud.

E930A198

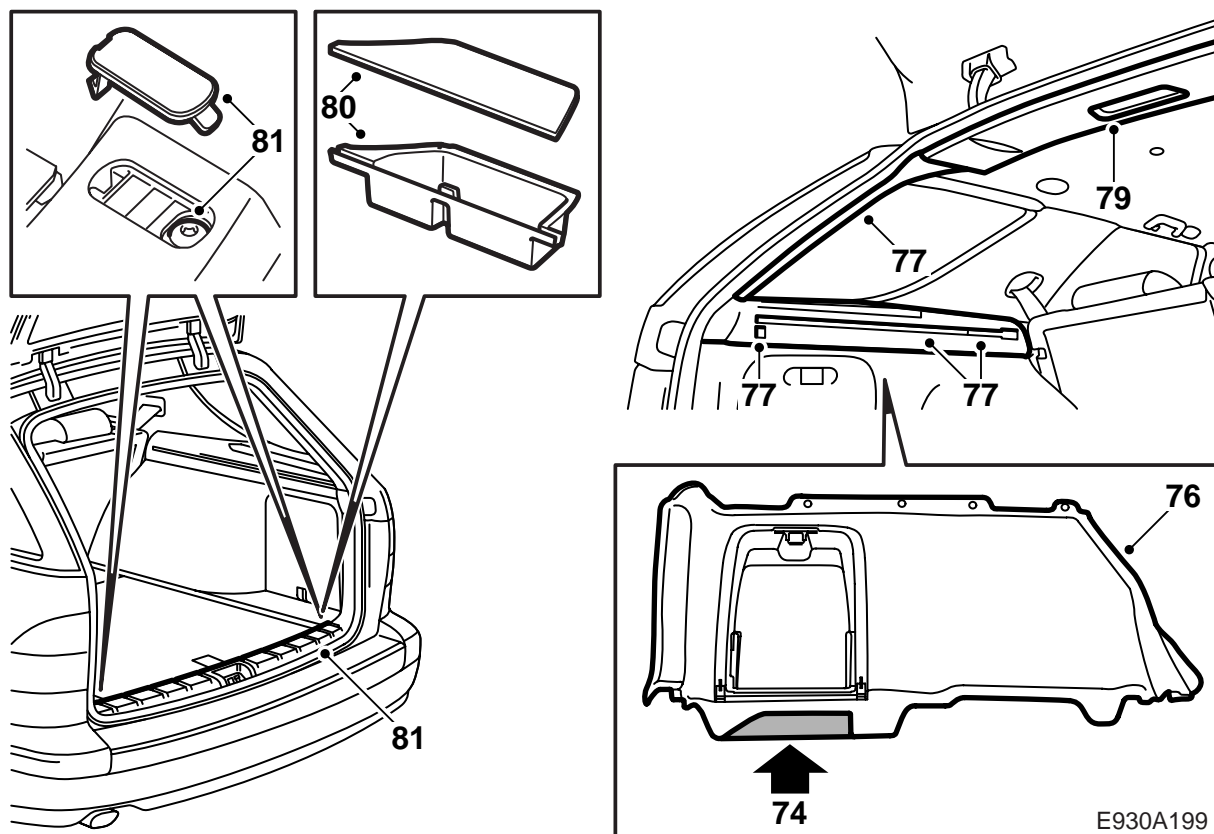

- 74 **5D:** Position the left-hand side trim. Mark with a pen on the trim around the navigation unit.
- 75 **5D:** Remove the side trim and saw around the mark. The sawing line from the rear corner should run obliquely downward-rearward towards the bend in the side trim.
- 76 **5D:** Position the side trim and fit the screws at the top of the side trim.
- 77 **5D:** Refit the luggage cover support (3 screws) and the D-pillar trim.
- 78 **5D:** Repeat steps 76-77 on the right hand side of the car.
- 79 **5D:** Press home the roof moulding.
- 80 **5D:** Fit the right-hand storage compartment in the floor.
- 81 **5D:** Refit the luggage cover.
- 82 **5D:** Fit the cover between the rear left door and the backrest and raise the rear seat backrest.
- 83 **5D:** Fit the carpet over the spare wheel and the luggage compartment floor.

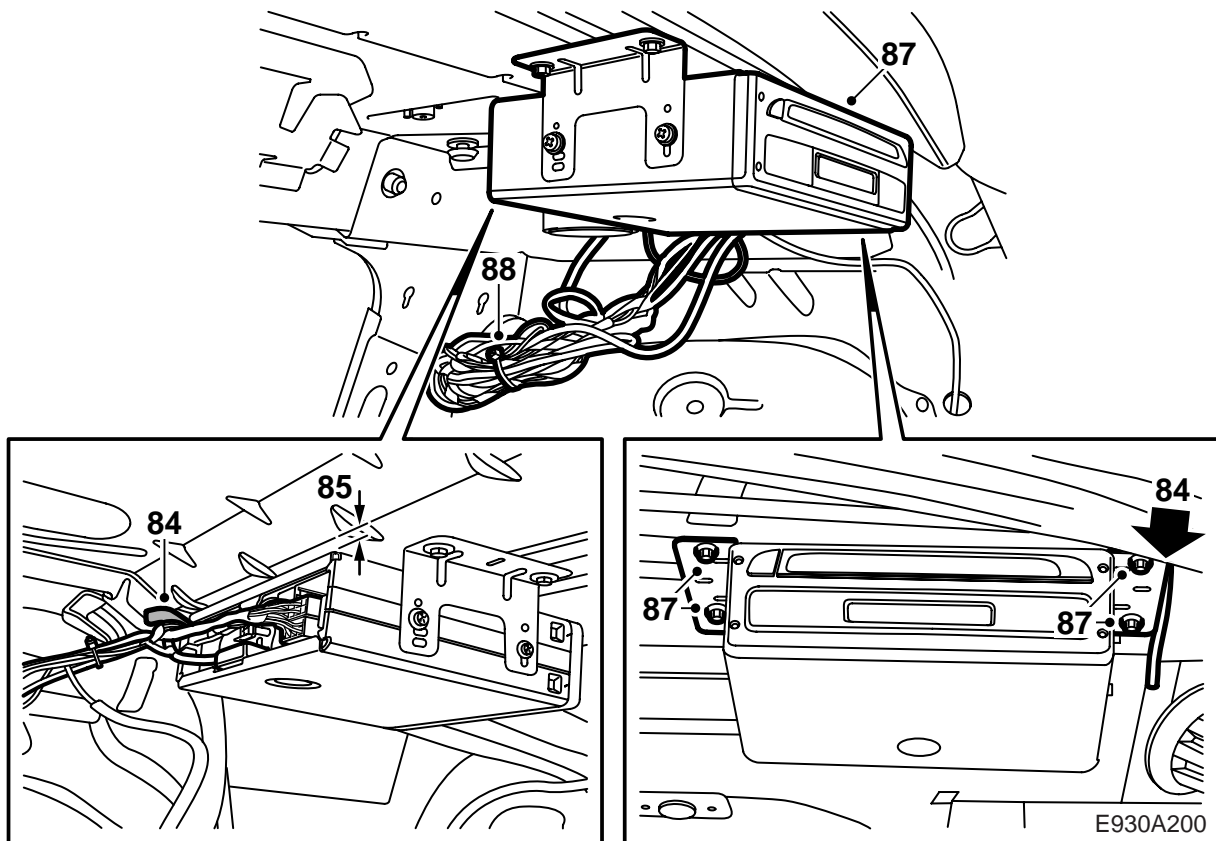

- 84 **4D:** Fit the wear protection on the vertical plate edge under the right-hand side of the parcel shelf to protect the navigation system wiring harness.
- 85 **4D:** Position the back of the navigation unit in line with the lower, rear fold in the parcel shelf and the right-hand bracket against the vertical plate edge under the right-hand side of the parcel shelf. Using the navigation unit attachment brackets as templates, mark where the four holes are to be drilled.
- 86 **4D:** Lift away the navigation unit and drill 3.5 mm holes at the marks.
Deburr the hole and remove any loose cuttings and flakes of paint. Clean with Teroson Cleaner FL, apply Standox 1K Füllprimer and apply finishing paint.
- 87 **4D:** Fit the navigation unit and angle it so the disc can easily be inserted.
- 88 **4D:** Gather together the wiring harnesses and secure them above the right-hand wheel housing.

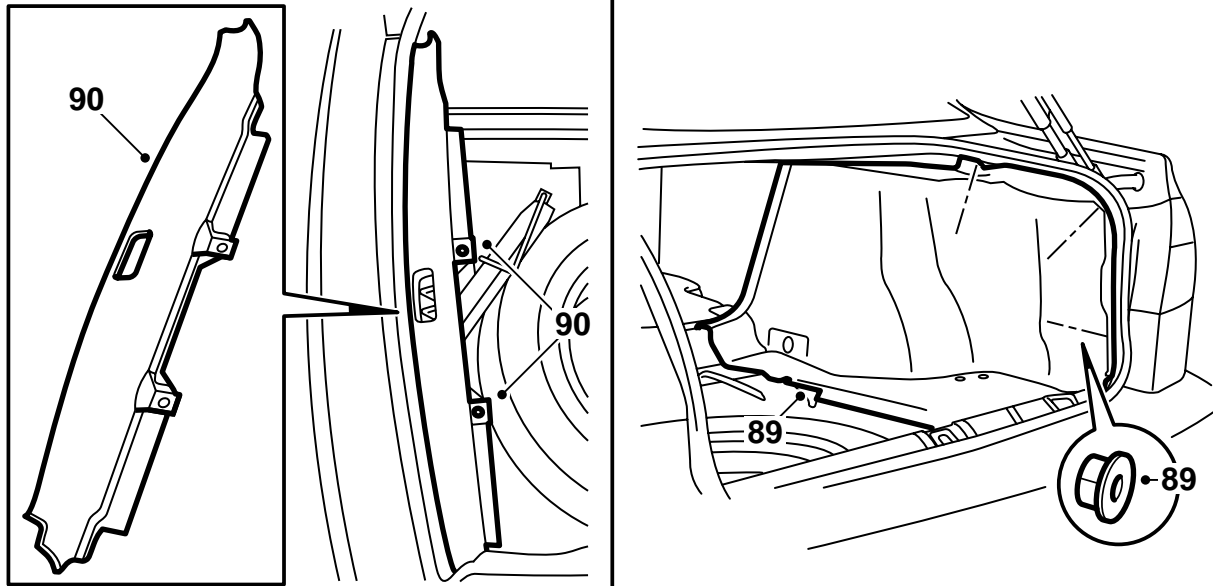

E930A201

- 89 **4D:** Fit the right-hand side trim in the luggage compartment and the luggage compartment floor.
- 90 **4D:** Fit the luggage compartment scuff plate.

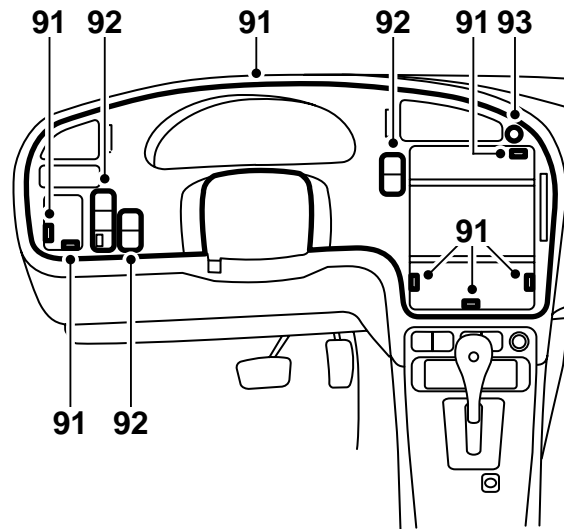
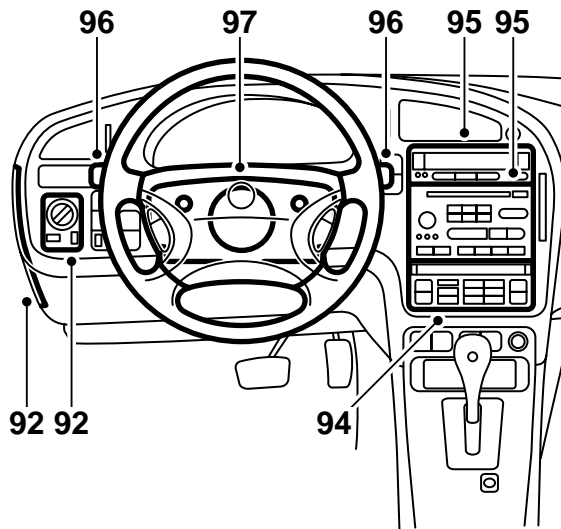

E930A202

- 91 Fit the instrument plate with 4 clips and 6 screws.
- 92 Connect the light switch panel and fit it together with the other switches.
Refit the cover on the side of the dashboard.
- 93 Fit the switch for the hazard flasher and plug in the connector from behind.

Note

There is a mark to show which end of the hazard flasher switch is up.

- 94 Connect and fit the heating and ventilation panel.
- 95 Connect and fit the SID unit and the radio section if present.
- 96 Fit the switches for the direction indicators and windscreen wipers.
- 97 Fit the steering column covers.
- 98 Fit the air duct on the passenger side.
- 99 **Cars with A/C:** Connect the cooler hose to the glove box.
- 100 Connect the glove box lighting and position the glove box.
- 101 Fit 3 retaining screws under and 3 retaining screws inside the glove box.
- 102 Connect the floor illumination in the lower dashboard panel.
- 103 Fit the lower dashboard panel under the glove box, 4 bolts. There are clips at the front.
- 104 Fit the cover for the heating and ventilation unit.
- 105 Fit the scuff plates on the right-hand side of the car.
- 106 Connect the battery and adjust the time and date on the car clock.

- 107 Insert a map CD into the navigation unit and park the car so that the GPS antenna above the dashboard is in free view of the sky.
- 108 Start the engine and check that the system screen comes on. Press OK on the remote control to show the main menu and activate the navigation system. This will take 2-10 minutes.
- 109 Select the "Map" function in the navigation system to see the map with the estimated position of the car. When GPS reception is sufficient, the GPS symbol will change colour from red to green and the system is then ready for use. Refer to the user instructions for further settings.
- 110 Place the remote control in its holder and make sure the keys are illuminated. Turn the light switch from 0-position to main/dipped beam position and make sure the screen illumination is subdued to night mode. Turn the light switch from main/dipped beam position to 0-position and make sure the screen illumination is increased to daylight mode.
- 111 Perform a road test on digitalized roads and check the function of the system in the following way:
- a Drive towards a road junction and make sure the distance indicator on the screen reacts correctly.
 - b Change direction several times and make sure the system reacts correctly.
 - c Reverse for a short way and check that the system reacts correctly and indicates the direction of travel.
- 112 Give the customer the installation instructions, CD for language selection, user instructions and reply coupon. Inform the customer that the reply coupon must be completed and sent to the addressee in order to obtain regular information regarding the navigation system. In addition to this, inform the customer that the system has defaulted to the factory settings because the battery has been disconnected.

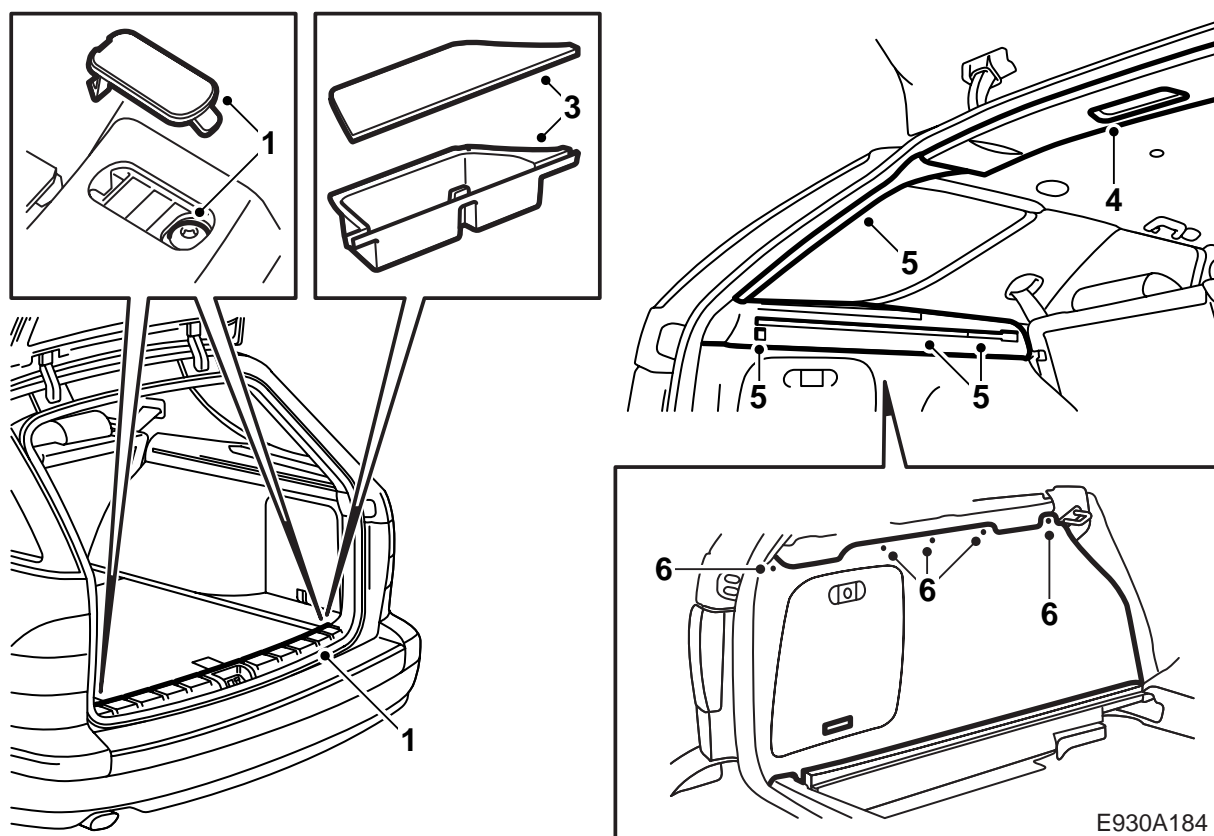

RHD

Disconnect the battery before commencing.

- 1 **5D:** Remove the luggage cover.
- 2 **5D:** Lower the left-hand rear backrest and remove the cover between the rear left door and the backrest.
- 3 **5D:** Remove the left-hand storage compartment in the floor.
- 4 **5D:** Remove the rear roof moulding and unplug the connections for the lighting.
- 5 **5D:** Remove the left-hand D-pillar trim and remove the left-hand luggage cover support (3 screws).
- 6 **5D:** Remove the screws from top of the left-hand side trim and lift out the left-hand side trim.
- 7 **5D:** Repeat steps 2-3 and 5-6 on the right-hand side of the car.
- 8 **5D:** Remove the luggage compartment floor and the clips at the front of the mat over the spare wheel.

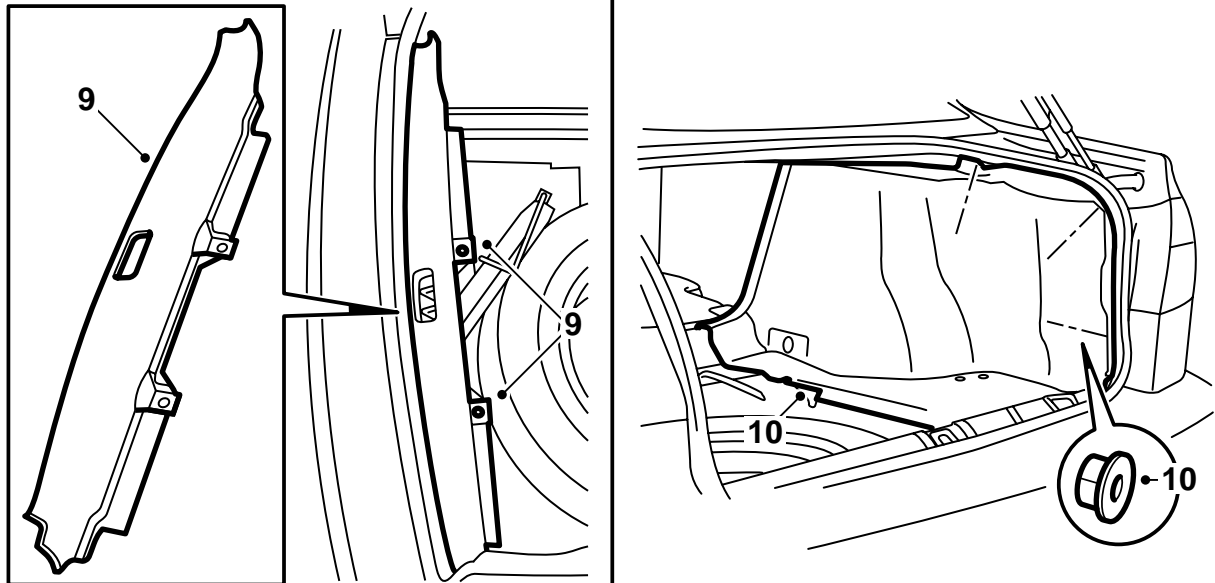

E930A185

- 9 **4D:** Remove the luggage compartment scuff plate.
- 10 **4D:** Remove the right-hand side trim in the luggage compartment and the luggage compartment floor.

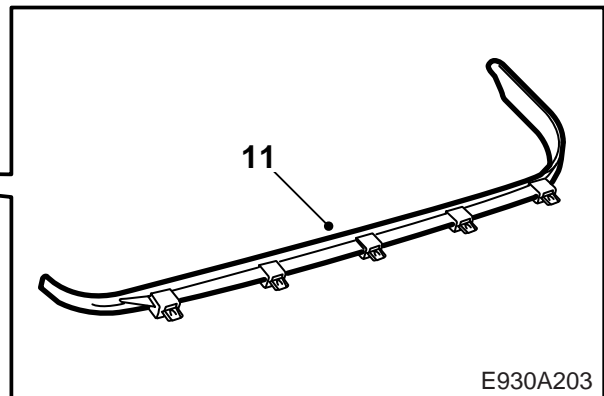
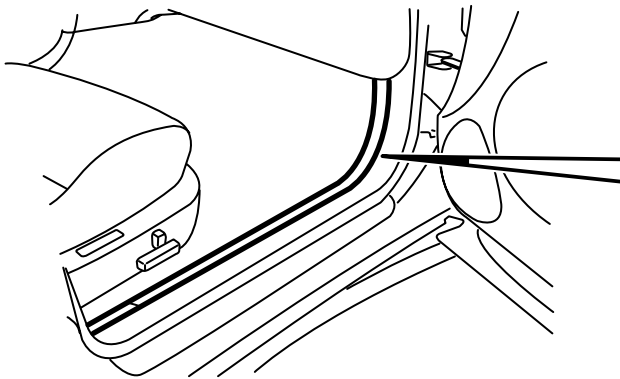
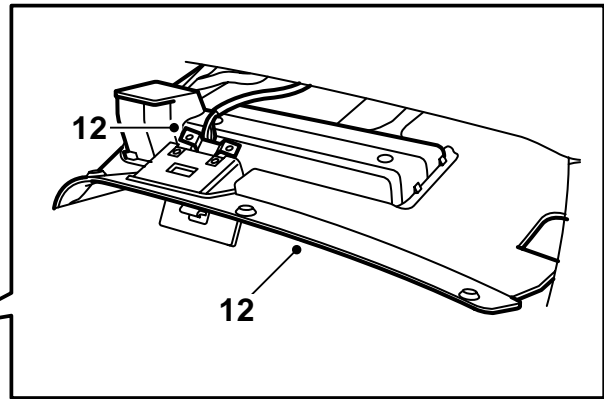
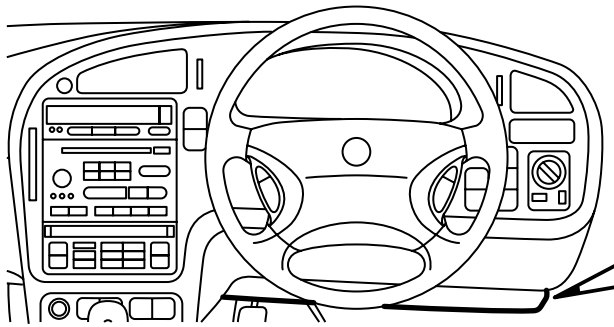

E930A203

- 11 Remove the scuff plates on the right-hand side of the car.
- 12 Remove the data link connector and the lower dashboard panel under the steering wheel, 3 screws.
- 13 Detach the floor illumination from the lower panel.

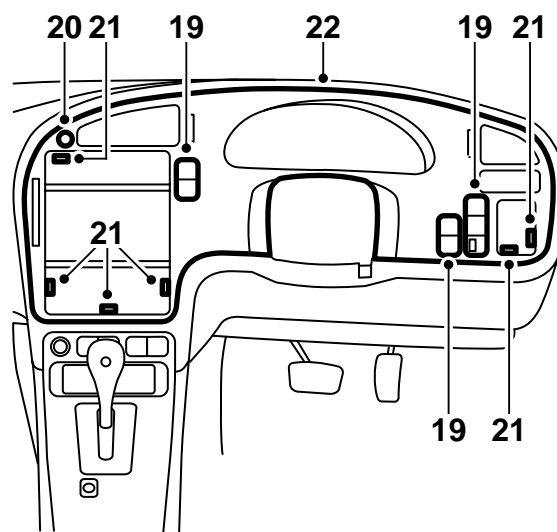
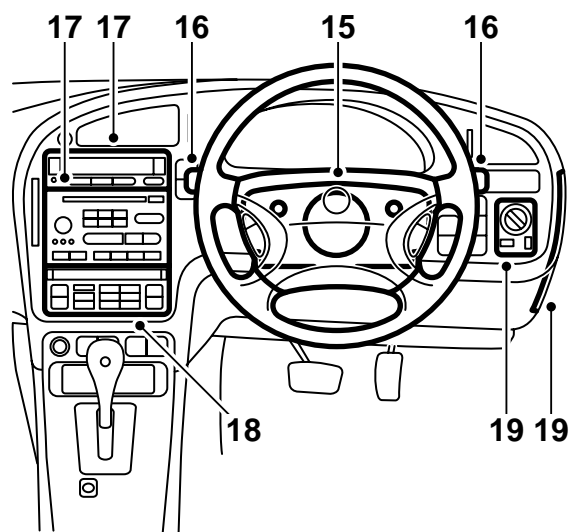

E930A204

- 14 Pull out the steering wheel to outermost and lowermost position.
- 15 Remove the top and bottom steering column covers, 3 screws.
- 16 Detach the switches for the direction indicators and windscreen wipers.
- 17 Remove the SID unit and the radio section. Unplug any connections and the antenna.
- 18 Remove the heating and ventilation panel and dismantle the connector.
- 19 Remove the main fuse board cover on the side of the panel. Remove the light control panel and the other switches and connectors.
- 20 Detach the switches for the hazard flasher and the connector.
- 21 Remove the instrument plate, 6 bolts and 4 clips.
- 22 Lift away the instrument plate.
- 23 Remove the screws from the boot on the steering column.
- 24 Remove four screws on the main instrument unit, unplug the two connector, one 24-pin and one 12-pin, and remove the main instrument unit.

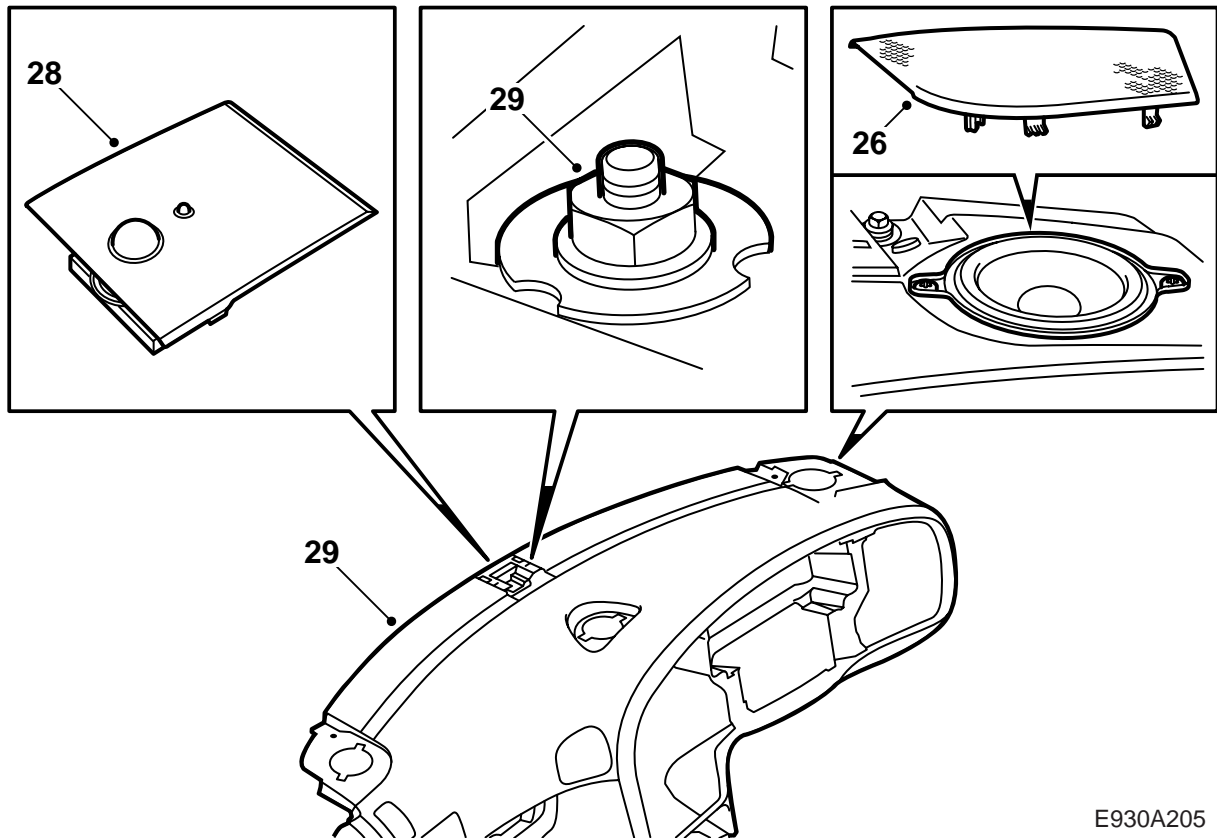

E930A205

- 25 Remove the A-pillar trim.
- 26 Remove the loudspeaker grille on both sides.
- 27 Remove the defroster cover clips on both sides.
- 28 Remove the cover with solar sensor and flasher diode.
- 29 Undo the nut for the defroster cover, the hole is elongated, and lift away the defroster cover.

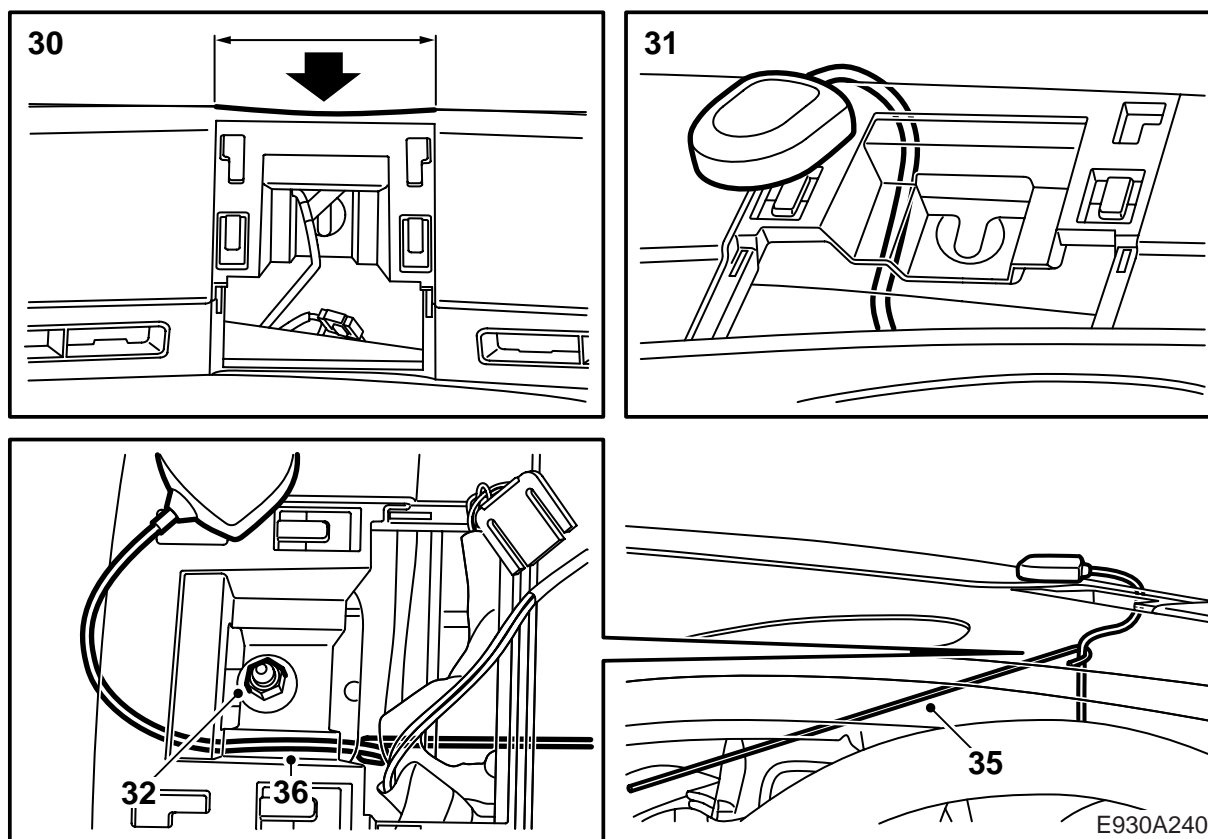

- 30 Round off the middle of the cover with a file to prevent the GPS antenna wiring harness from chafing against sharp edges.
- 31 Run the GPS antenna wiring harness around the front of the cover.
- 32 Position the defroster cover and tighten the nut. Make sure the length of the wiring harness can be adjusted easily.
- 33 Fit the clips and the loudspeaker grilles on both sides.
- 34 Fit the A-pillar trim.
- 35 Insert a bent welding rod inside the dashboard over the centre ventilation duct towards the position for the solar sensor.
- 36 Place the GPS antenna wiring harness so that it can be pulled out using the welding rod.

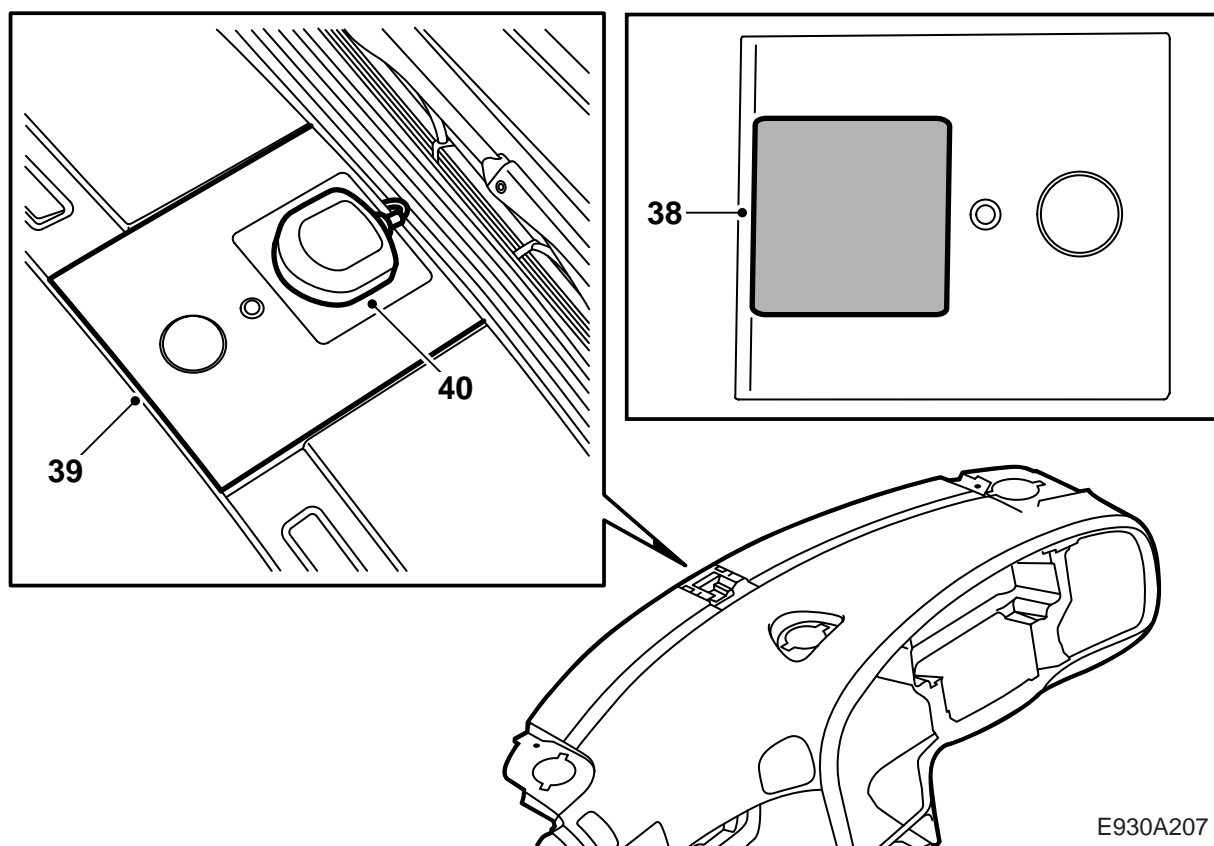

E930A207

- 37 Clean the surface on the GPS antenna grounding surface with white spirit where the tape is to be affixed. Affix the tape to the GPS antenna grounding surface.
- 38 Clean the surface on the cover with the solar sensor with white spirit where GPS antenna is to be mounted in the centre and fit the GPS antenna grounding surface with its holes in the longitudinal direction of the car.
- 39 Connect the solar sensor and flasher diode and fit the cover.
- 40 Fit the GPS antenna in the centre of the attachment plate. The GPS antenna is magnetic.

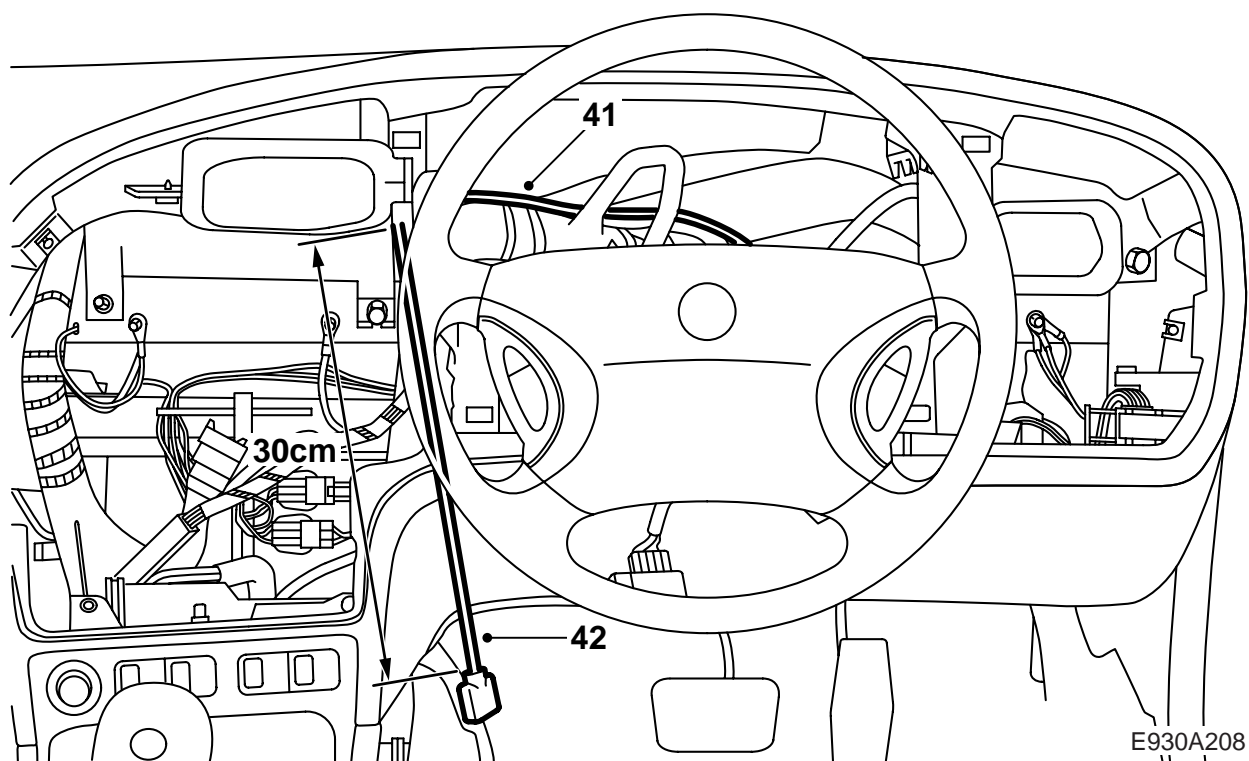

E930A208

- 41 Move the GPS antenna wiring harness to the right towards the existing wiring harness behind the impact member (instrument unit).
- 42 Run the screen wiring harness via the existing wiring harness and allow about 30 cm to protrude from the heating and ventilation unit.

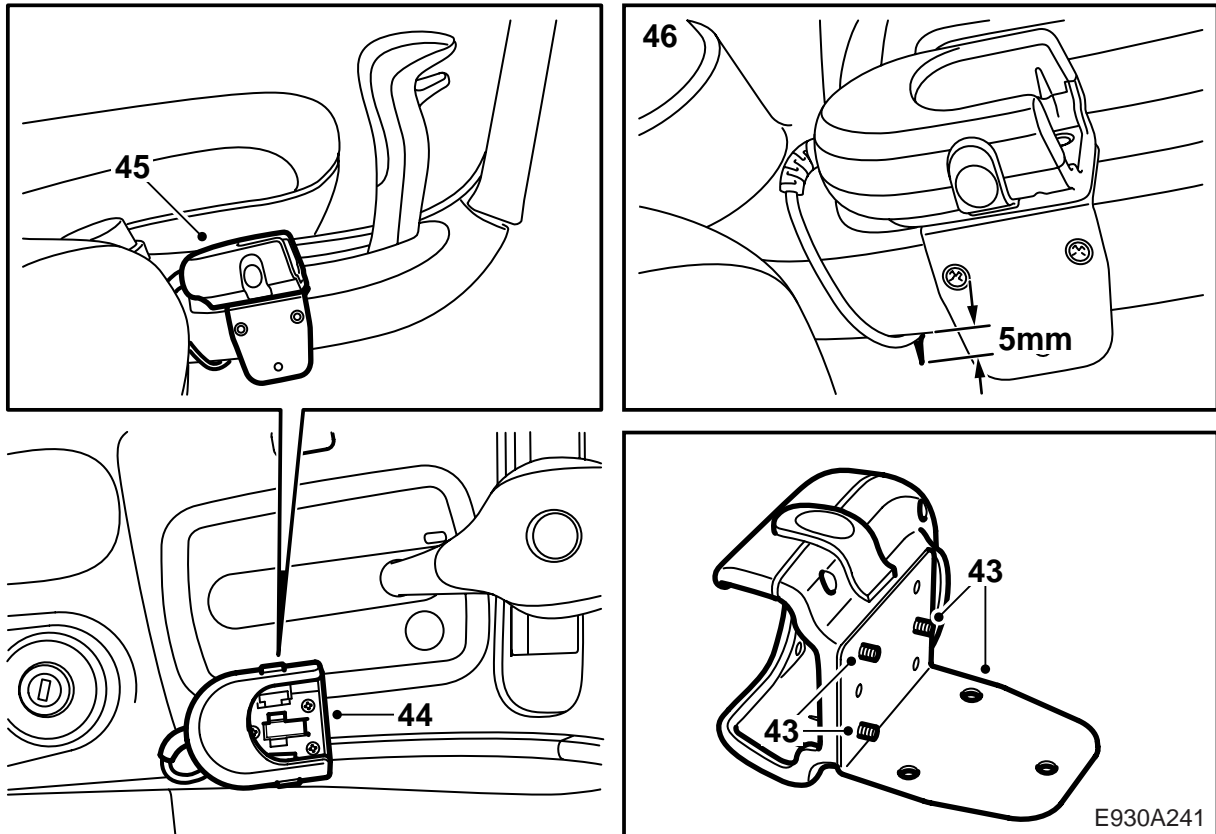

- 43 Assemble together the console for the remote control and the remote control attachment bracket with three screws.
- 44 Place the remote control console on the centre console to the right of the gear lever, about 20-25 mm in front of the ignition switch. The screws for the remote control carrier must not reach the centre console.
- 45 Drill a 2.5 mm hole using the bracket as a template. Secure it with one screw and drill the second hole. Attach the console with two screws.
- 46 Cut a 5 mm long slit in the carpet along the back edge of the remote control console. Measure the length from the join between the carpet and the centre console.
- 47 Remove the remote control console and fold away the carpet.

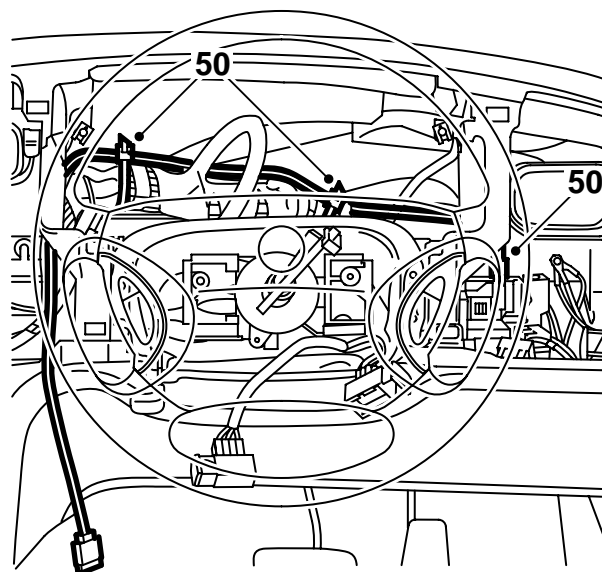
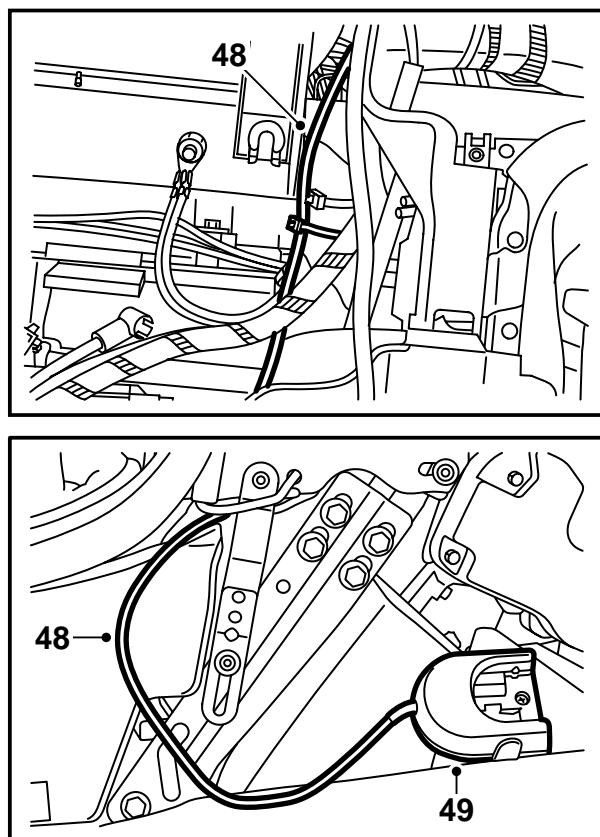

E930A210

- 48 Run the remote control wiring harness behind the floor carpet by the centre console, along the existing wiring harness towards the space behind the radio and then to the right, where it connects to the remote control wiring harness. Place the connectors behind the instrument unit as close to the right-hand A-pillar as possible.
- The wiring harness from the remote control has a connector that is intended for an extra loudspeaker. This connector is not used and is to be secured together with the other connectors.
- 49 Position and fit the carpet and the remote control console.
- 50 Gather up all the wiring harnesses and secure them with 3 cable ties to the member behind the instrument unit.
- 51 Position the main instrument unit correctly and plug in the two connectors.
- 52 Screw on the main instrument unit with the four screws.
- 53 Fit the screws in the boot on the steering column.

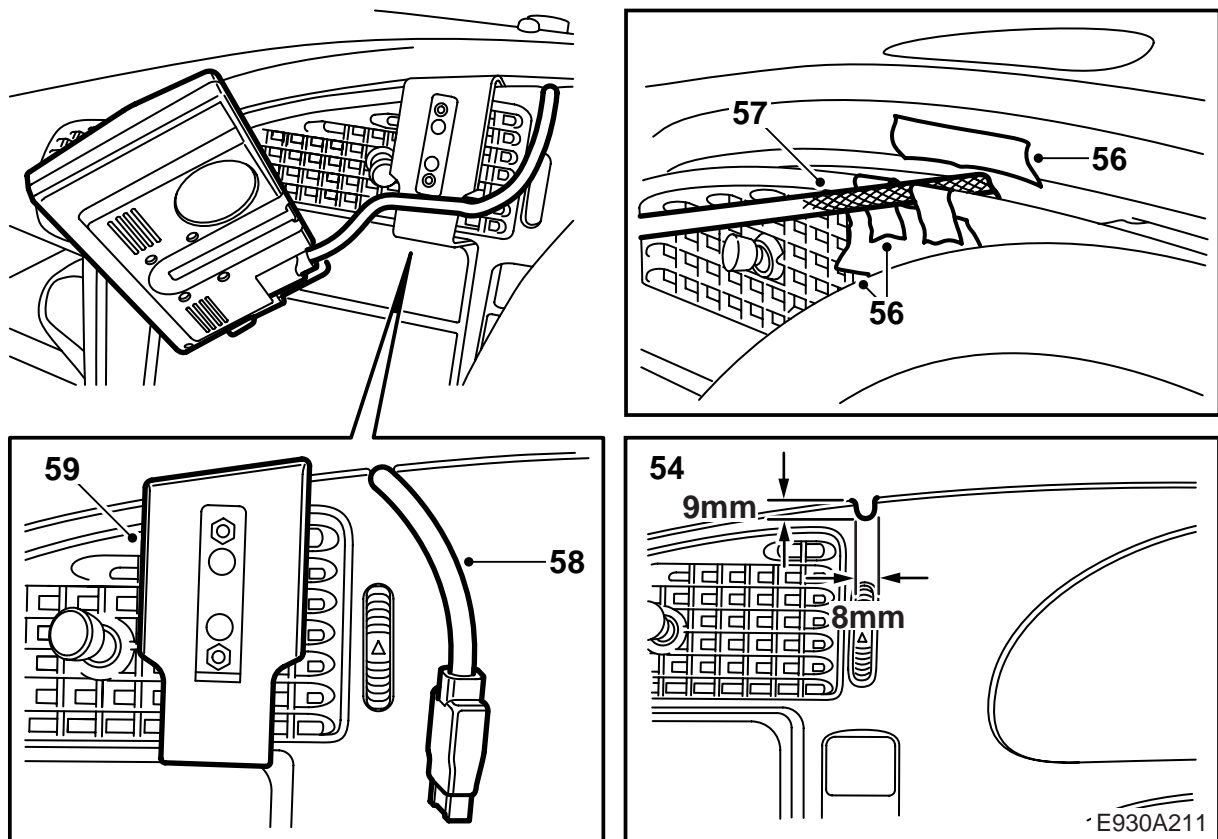

- 54 Make a hole 8 mm wide and 9 mm high with a file on top of the instrument plate above the air vent shutter control. Check that the screen wiring harness can be placed easily in the hole.
- 55 Position the instrument plate in the dashboard without snapping it on. Check from the driver side that the air ducts are positioned correctly.
- 56 Affix a piece of tape on the dashboard by the filed hole in the instrument plate and affix tape around the filed hole in the instrument plate.
- 57 Carefully file a hole in the dashboard through the hole in the instrument plate.
- 58 Place the screen wiring harness into the hole and make sure the wiring harness fits easily into the filed hole.
- 59 Fit the screen mounting bracket to the instrument plate.
- 60 Press on the instrument plate.

⚠ WARNING

Take care when fitting and make sure none of the connectors or cables are jammed.

- 61 Connect the wiring harness to the screen and fit the screen into the mounting bracket.
- 62 Adjust the length of the wiring harness. It should be possible to remove the screen if necessary.

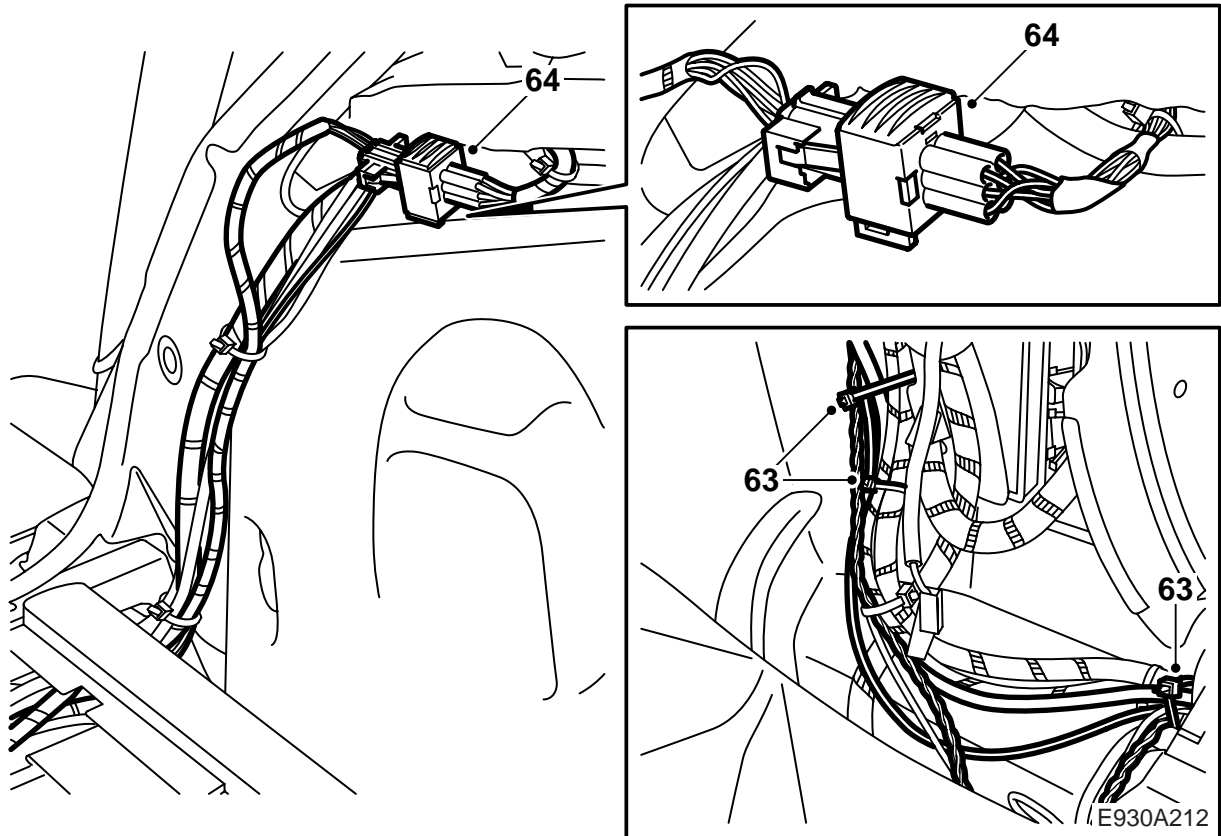

- 63 Run the wiring harness down towards the wiring harness channel in the right-hand skill and on towards the rear wheel housing. Secure the wiring harness with 3 cable ties at the A-pillar, 1 cable tie at each end of the wiring harness channel (4 pcs) and 2 cable ties at the front of the rear wheel housing.
- 64 The cable harness has been prewired for the navigation system at the rear wheel housing. Cut off any cable ties present and connect the wiring harnesses.

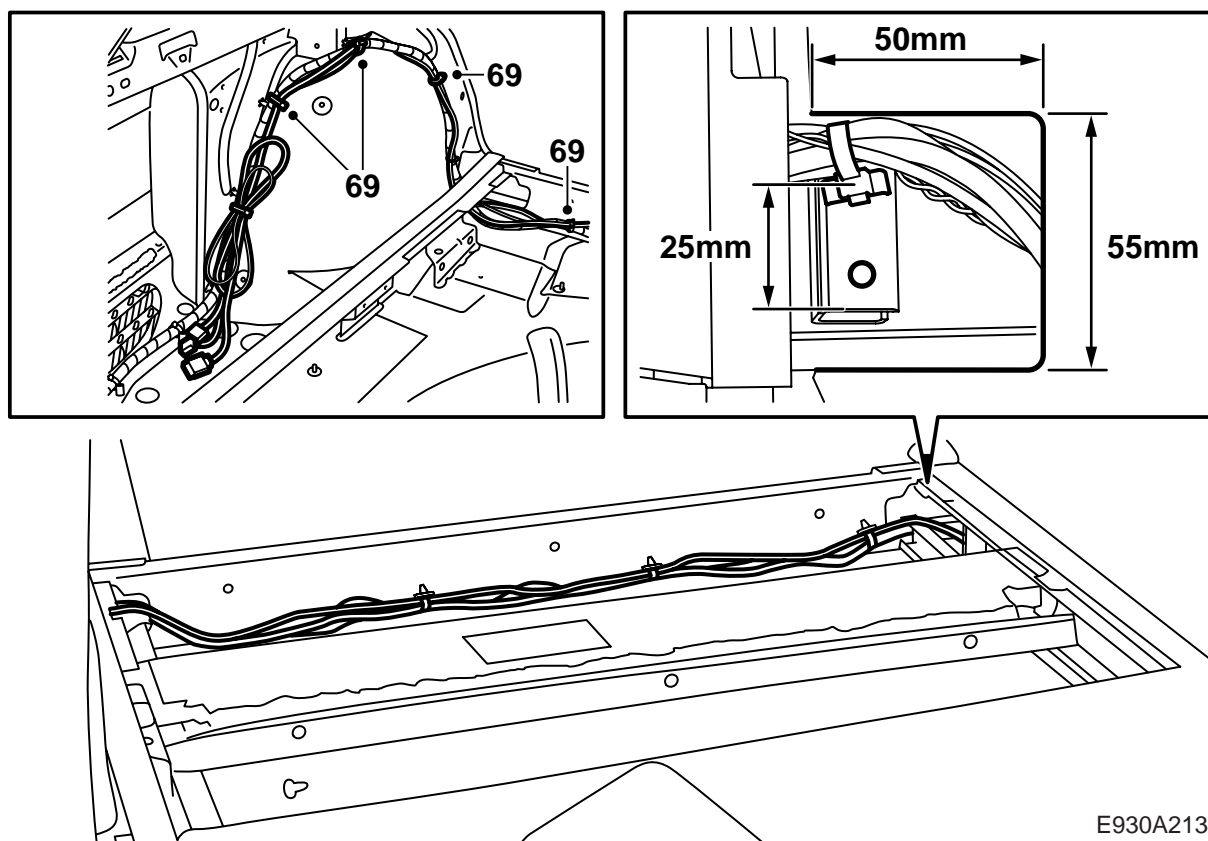

E930A213

- 65 **5D:** Run all the wiring harnesses along the member behind the rear seat backrest and secure them together with any other wiring harnesses. If there are no other wiring harnesses, use cable ties to secure the wiring harness for the navigation system to the 5 holes in the body.
- 66 **5D cars with extendable luggage compartment floor:** Cut out both sides of the carpet to allow the wiring harness to pass over the rails on the luggage compartment floor. The cut-out should be 55 mm long, measured from the front fold of the carpet towards the rear of the car, and 50 mm wide, measured from the edge of the carpet towards the centre.
- 67 **5D cars with extendable luggage compartment floor:** Check whether there are any holes 25 mm from the front of the rails for the front wheels of the luggage compartment floor. If there are not any holes, drill 6.5 mm holes in each rail. Drill the holes 25 mm from the front of the rails.
- 68 **5D cars with extendable luggage compartment floor:** Secure the wiring harness to the luggage compartment floor rails using cable ties and clips. Adjust the cut-out in the carpet as necessary.
- 69 **5D:** Run the wiring harnesses along the left wheel housing via the car's wiring harness down to the where the navigation unit is located.

Important

The carpet must not lie on top of the wiring harness as this will affect the function of the extendable luggage compartment floor.

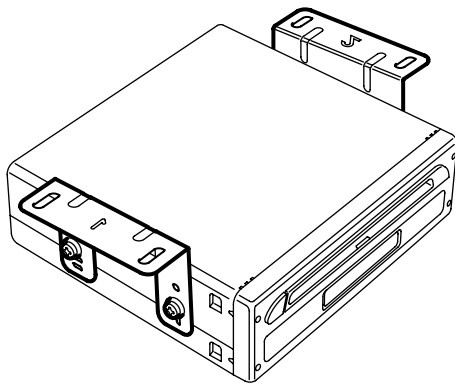
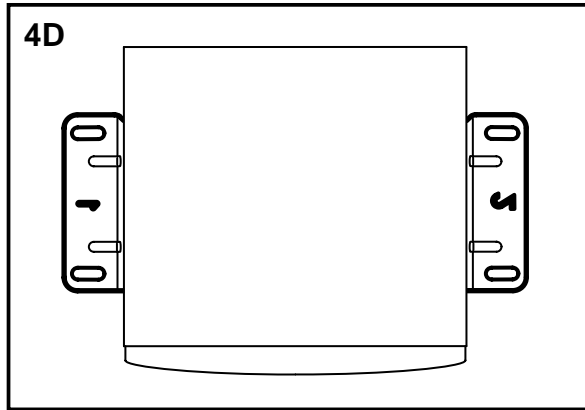

5D

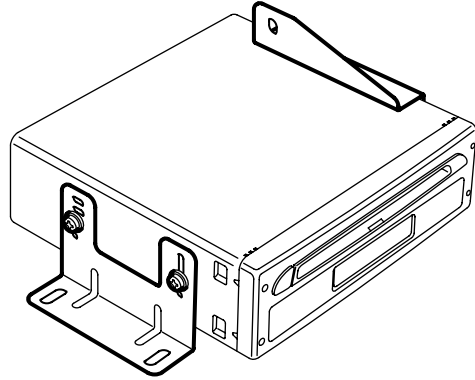

E930A197

70 Fit the rubber guide on the pin on the rear of the navigation unit and insert the navigation unit into the mounting frame.

Important

The depression in the mounting frame must be located underneath the navigation unit.

Press in the navigation unit until it snaps into the mounting frame and then fit the brackets to the mounting frame.

4D: The angle bracket marked 1 must be fitted on the LH side of the navigation unit and the angle bracket marked 2 must be fitted to the RH side of the navigation unit. The rear screw must be located in the horizontal oval hole closest to the circular hole and the front screw must be located in the vertical oval hole.

5D: The angle bracket marked 2 must be fitted on the LH side of the navigation unit and the stepped bracket must be fitted to the RH side of the navigation unit. The rear screw in the LH bracket must be located in the horizontal oval hole closest to the circular hole and the front screw must be located in the vertical oval hole.

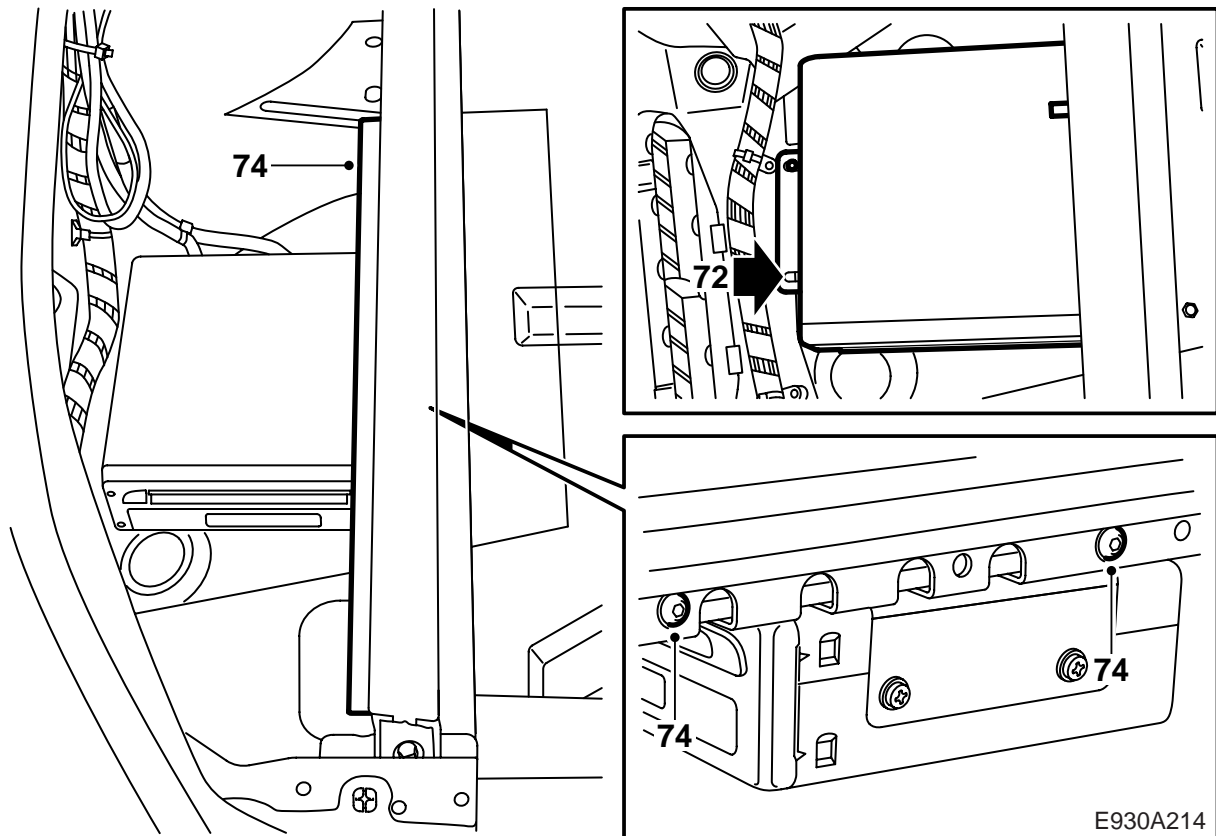

71 Connect the navigation unit.

72 **5D:** Detach the wiring harness cable tie from the weld stud, position the navigation unit with the weld stud in the front attachment hole on the left-hand side and the right-hand bracket secured to the load anchor rail. Make a mark through the rear hole on the left-hand side of the navigation unit.

73 **5D:** Lift away the navigation unit and drill a 3.5 mm hole at the mark.

Deburr the hole and remove any loose cuttings and flakes of paint. Clean with Teroson Cleaner FL, apply Standox 1K Füllprimer and apply finishing paint. Use Terotex HV 400 underneath the body.

74 **5D:** Fit the navigation unit with the weld stud in the front attaching hole on the left-hand side, one screw in the drilled hole and the right-hand bracket fitted to the load anchor rail together with the support for the left-hand storage compartment lid. Lift up the navigation unit as high as possible when tightening the screw in the load anchor rail. If the car is equipped with extendable luggage compartment floor, the screws for its front attachment must be used.

Attach the wiring harness cable tie to the weld stud.

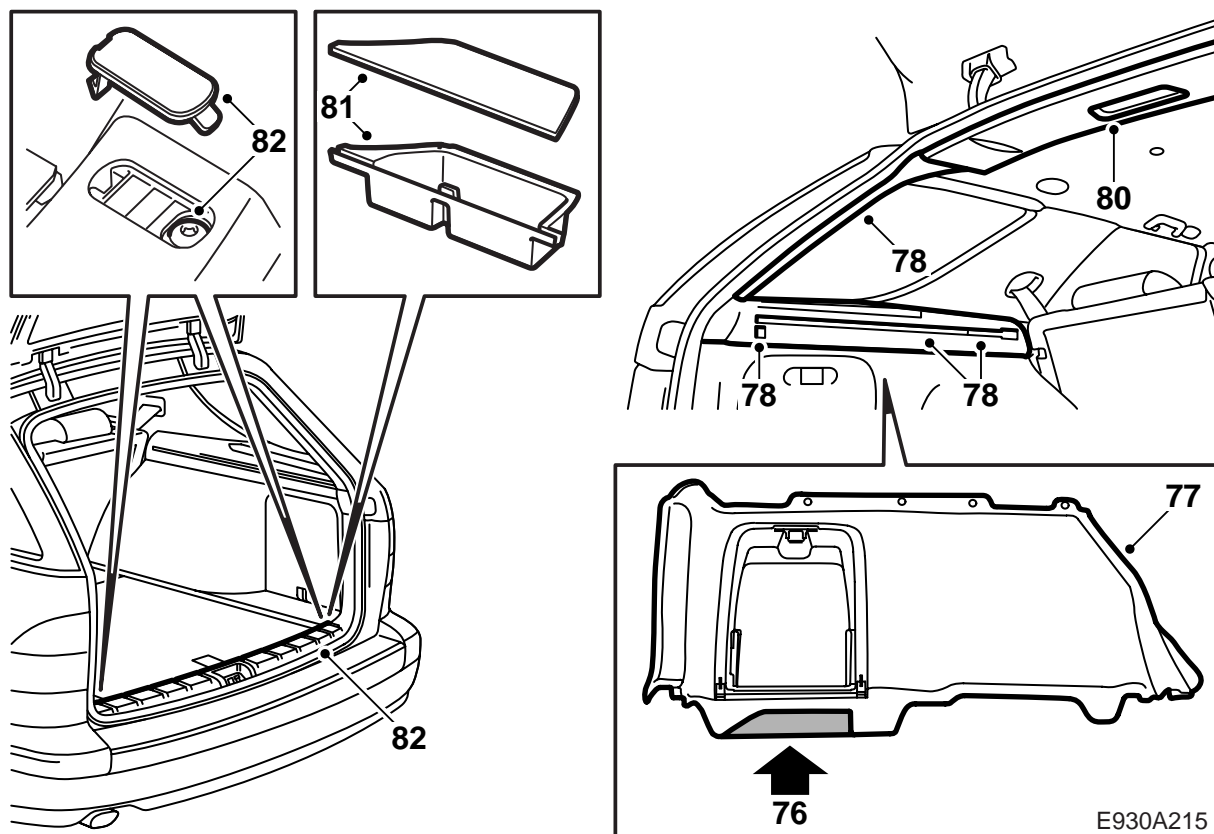

- 75 **5D:** Position the left-hand side trim. Mark with a pen on the trim around the navigation unit.
- 76 **5D:** Remove the side trim and saw around the mark. The sawing line from the rear corner should run obliquely downward-rearward towards the bend in the side trim.
- 77 **5D:** Position the side trim and fit the screws at the top of the side trim.
- 78 **5D:** Refit the luggage cover support (3 screws) and the D-pillar trim.
- 79 **5D:** Repeat steps 77-78 on the right hand side of the car.
- 80 **5D:** Press home the roof moulding.
- 81 **5D:** Fit the right-hand storage compartment in the floor.
- 82 **5D:** Refit the luggage cover.
- 83 **5D:** Fit the cover between the rear left door and the backrest and raise the rear seat backrest.
- 84 **5D:** Fit the carpet over the spare wheel and the luggage compartment floor.

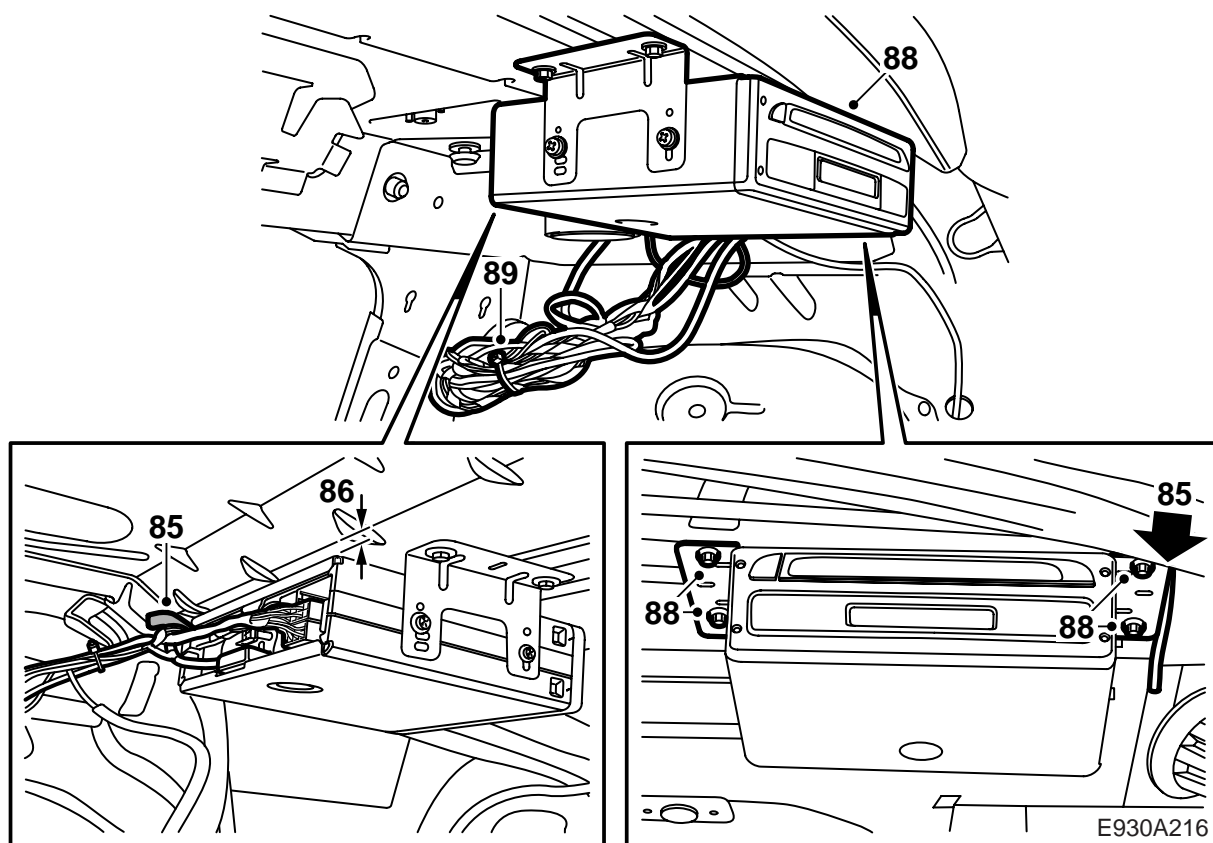

85 **4D:** Fit the wear protection on the vertical plate edge under the right-hand side of the parcel shelf to protect the navigation system wiring harness.

86 **4D:** Position the back of the navigation unit in line with the lower, rear fold in the parcel shelf and the right-hand bracket against the vertical plate edge under the right-hand side of the parcel shelf. Using the navigation unit attachment brackets as templates, mark where the four holes are to be drilled.

87 **4D:** Lift away the navigation unit and drill 3.5 mm holes at the marks.

Deburr the hole and remove any loose cuttings and flakes of paint. Clean with Teroson Cleaner FL, apply Standox 1K Füllprimer and apply finishing paint.

88 **4D:** Fit the navigation unit and angle it so the disc can easily be inserted.

89 **4D:** Gather together the wiring harnesses and secure them above the right-hand wheel housing.

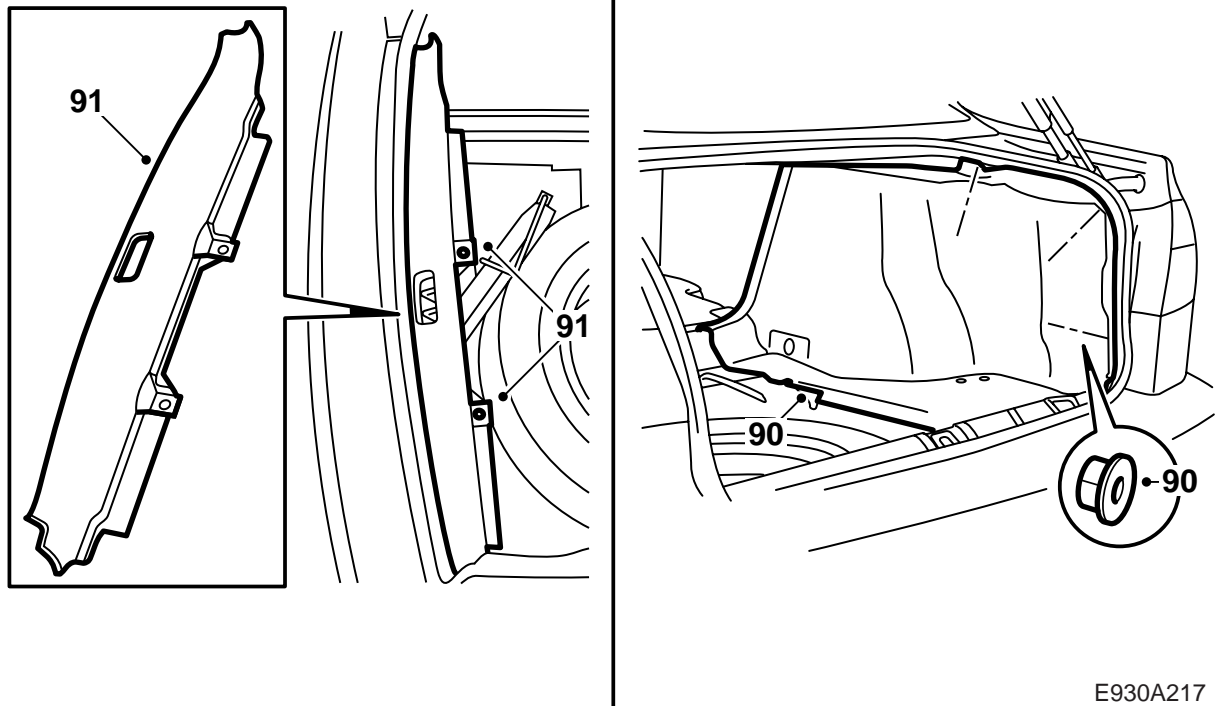

E930A217

- 90 **4D:** Fit the right-hand side trim in the luggage compartment and the luggage compartment floor.
- 91 **4D:** Fit the luggage compartment scuff plate.

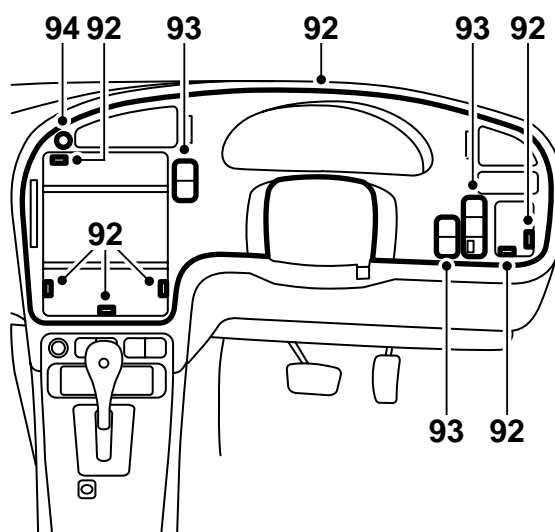
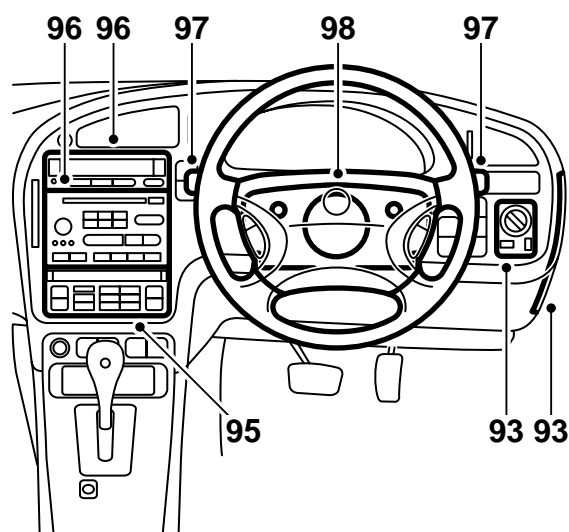

E930A218

- 92 Fit the instrument plate with 4 clips and 6 screws.
- 93 Connect the light switch panel and fit it together with the other switches.
Refit the cover on the side of the dashboard.
- 94 Fit the switch for the hazard flasher and plug in the connector from behind.

Note

There is a mark to show which end of the hazard flasher switch is up.

- 95 Connect and fit the heating and ventilation panel.
- 96 Connect and fit the SID unit and the radio section if present.
- 97 Fit the switches for the direction indicators and windscreen wipers.
- 98 Fit the steering column covers.
- 99 Connect the floor illumination in the lower dashboard panel.
- 100 Fit the lower dashboard panel under the steering wheel, 3 screws, and the data link connector.
- 101 Fit the scuff plates on the right-hand side of the car.
- 102 Connect the battery and adjust the time and date on the car clock.

- 103 Insert a map CD into the navigation unit and park the car so that the GPS antenna above the dashboard is in free view of the sky.
- 104 Start the engine and check that the system screen comes on. Press OK on the remote control to show the main menu and activate the navigation system. This will take 2-10 minutes.
- 105 Select the "Map" function in the navigation system to see the map with the estimated position of the car. When GPS reception is sufficient, the GPS symbol will change colour from red to green and the system is then ready for use. Refer to the user instructions for further settings.
- 106 Place the remote control in its holder and make sure the keys are illuminated. Turn the light switch from 0-position to main/dipped beam position and make sure the screen illumination is subdued to night mode. Turn the light switch from main/dipped beam position to 0-position and make sure the screen illumination is increased to daylight mode.
- 107 Perform a road test on digitalized roads and check the function of the system in the following way:
- a Drive towards a road junction and make sure the distance indicator on the screen reacts correctly.
 - b Change direction several times and make sure the system reacts correctly.
 - c Reverse for a short way and check that the system reacts correctly and indicates the direction of travel.
- 108 Give the customer the installation instructions, CD for language selection, user instructions and reply coupon. Inform the customer that the reply coupon must be completed and sent to the addressee in order to obtain regular information regarding the navigation system. In addition to this, inform the customer that the system has defaulted to the factory settings because the battery has been disconnected.